

NOTICE!!

These documents have been scanned!

Do not place un-scanned documents beneath this notice!

Do not remove this notice from this file!

GPO Jacket No. 560-102
Print Order 61540
Rise Business Services, LLC
Job=AZ15 6/3/2019



Box Number= AZ15110



Claim Begin-End: AMC368387-AMC368388

1 Initial Receipt

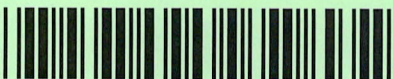

AZ15110-7

AMC367879-AMC368659

Closed

368387

If additional information is required, please contact TONY SMITH @ 602-417- 9355. Please include your AMC serial number(s) on all correspondence.

Stephen K. Hansen
Acting Group Administrator
Lands and Minerals

United States Department of the Interior
Bureau of Land Management
 BUSINESS & SUPPORT SVCS DIV
 ONE N CENTRAL AVE
 PHOENIX, AZ 85004 -2203
 Phone: (602) 417-9200

Receipt	
No:	1187965

Transaction #: 1228033
Date of Transaction: 11/21/2005

ENTERED INTO COMPUTER
 DEC 09 2005 *LB*

CUSTOMER:	TED BIGELOW PO BOX 323 WITTMANN, AZ 85361
------------------	---

LINE #	QTY	DESCRIPTION	REMARKS	UNIT PRICE	TOTAL
1	2.00	LOCATABLE MINERALS / MINING CLAIMS-NEW, UNADJUD, ONE OR MORE AUTH NOS / NEW MINING CLAIM LOCATION FEE \$30 (1993) CASES: AMC368387/\$30.00, AMC368388/\$30.00		- n/a -	60.00
2	2.00	LOCATABLE MINERALS / MINING CLAIMS-NEW, UNADJUD, ONE OR MORE AUTH NOS / NEW MINING CLAIM PROCESSING FEE \$15 (1930) CASES: AMC368387/\$15.00, AMC368388/\$15.00		- n/a -	30.00
3	2.00	LOCATABLE MINERALS / MINING CLAIMS-NEW, UNADJUD, ONE OR MORE AUTH NOS / NEW MINING CLM MAINT FEE \$125 (1993) CASES: AMC368387/\$125.00, AMC368388/\$125.00	CLAIM MAIN 2006 (2)	- n/a -	250.00
TOTAL:					\$340.00

PAYMENT INFORMATION			
NOTE: Items will appear on credit card statement as "Bureau of Land Management".			
1	AMOUNT:	\$340.00	POSTMARKED: N/A
	TYPE:	CREDIT CARD	RECEIVED: 11/21/2005
	NAME:	BIGELOW, TED PO BOX 323 WITTMANN AZ 85361	
	CARD NO:	XXXXXXXXXXXX5418	AUTH CODE: 005713
	NAME ON CARD:	BIGELOW/THEODORE S	
	EXPIRES:	09/30/2007	
	SIGNATURE:		

REMARKS

This receipt was generated by the automated BLM Collections and Billing System and is a paper representation of a portion of the official electronic record contained therein.

NOTICE!!

These documents have been scanned!

Do not place un-scanned documents beneath this notice!

Do not remove this notice from this file!

GPO Jacket No. 560-102
Print Order 61540
Rise Business Services, LLC
Job=AZ15 6/3/2019



Box Number= AZ15110



Claim Begin-End: AMC368387-AMC368388

2 Correspondence



AZ15110-7

AMC367879-AMC368659

5/25/2010
TS
AT 5/25/10
S/Hansen
5/25/10

MAY 26 2010

In Reply Refer To:

3800 (9310) TS

AMC367671, AMC368387

AMC381023

CERTIFIED MAIL - RETURN RECEIPT REQUESTED No. 7009 1410 0001 7124 5224

DECISION

George & Joan Bernier : AMC367671, AMC368387, AMC381024
5662 Vinevale Circle : Rainbows End #5, and #8,
La Palma, California 90623 : Thunder Canyon

MINING CLAIMS
DECLARED FORFEITED

The mining claims listed above have been declared forfeited for failure to file the required affidavit of labor.

A small miner's maintenance fee waiver certification was received, requesting a waiver of the maintenance fees for the 2009 assessment year. Pursuant to regulations found at 43 CFR 3835.16 and 3835.31, an affidavit of labor must have been filed on or before December 30, 2009, along with a \$10 processing fee per claim. Failure to timely file this affidavit and fee constitutes a forfeiture of the claims (43 CFR 3835.91). Although the maintenance fees were paid for the claims for the 2010 assessment year this does not relieve the requirement to file the affidavit of labor for the 2009 assessment year, (for the time period the waiver covered), which was due on or before December 30, 2009.

Our records do not show receipt of a 2009 affidavit of labor for the mining claims listed above, and therefore the claims are declared forfeited.

You are required to reclaim all areas disturbed by your activities on lands encompassed by your mining claim. After you complete the reclamation, you must notify the authorized officer of the appropriate surface managing agency so that the authorized officer may conduct a final site inspection and determine whether you may be released from liability. If you fail to reclaim the land to the satisfaction of the authorized officer, the surface management agency may cite you for noncompliance under its surface management regulations.

8/23/2010 TS
ENTERED INTO COMPUTER

For land administered by the Bureau of Land Management (BLM), if you fail to reclaim the land to the satisfaction of the authorized officer as required in 43 CFR Subpart 3809, BLM will issue an order of noncompliance under 43 CFR 3809.601(a). If you fail to comply with the noncompliance order, BLM may take further action under 43 CFR 3809.604. Failure to conduct reclamation is a prohibited act that may subject you to criminal penalties. See 43 CFR 3809.605(h) and 43 CFR 3809.700.

This decision may be appealed to the Interior Board of Land Appeals, Office of the Secretary, in accordance with the regulations contained in 43 CFR, Part 4 and the enclosed Form 1842-1. If an appeal is taken, your notice of appeal must be filed in this office (at the above address) within 30 days from receipt of this decision. The appellant has the burden of showing that the decision appealed from is in error.

If you wish to file a petition pursuant to regulation 43 CFR 4.21 (58 FR 4939, January 19, 1993) for a stay of the effectiveness of this decision during the time that your appeal is being reviewed by the Board, the petition for a stay must accompany your notice of appeal. A petition for a stay is required to show sufficient justification based on the standards listed below. Copies of the notice of appeal and petition for a stay **must** also be submitted to each party named in this decision and to the Interior Board of Land Appeals and to the appropriate Office of the Solicitor (see 43 CFR 4.413) at the same time the original documents are filed with this office. If you request a stay, you have the burden of proof to demonstrate that a stay should be granted.

Standards for Obtaining a Stay

Except as otherwise provided by law or other pertinent regulation, a petition for a stay of a decision pending appeal shall show sufficient justification based on the following standards:

- (1) The relative harm to the parties if the stay is granted or denied,
- (2) The likelihood of the appellant's success on the merits,
- (3) The likelihood of immediate and irreparable harm if the stay is not granted, and
- (4) Whether the public interest favors granting the stay.

Please include your AMC serial number on all correspondence. If additional information is required, please contact Tony Smith at 602- 417- 9355.

/s/ Stephen K. Hansen
Stephen K. Hansen
Acting Group Administrator
Lands and Minerals Group

Enclosure
Appeal Form 1842-1

TSmith:lm:052410

NOTICE!!

These documents have been scanned!

Do not place un-scanned documents beneath this notice!

Do not remove this notice from this file!

GPO Jacket No. 560-102
Print Order 61540
Rise Business Services, LLC
Job=AZ15 6/3/2019



Box Number= AZ15110



Claim Begin-End: AMC368387-AMC368388

3 Transfers



AZ15110-7

AMC367879-AMC368659

QUIT CLAIM DEED

AMC 368387

GRANTOR

Zerad, LLC, an Arizona limited liability company

GRANTEE

Zeco, Inc, an Arizona corporation

For valuable consideration, the sufficiency of which is hereby acknowledged, the Grantor quit claims to Grantee all right, title, and interest of Grantor in the real property situated in Yavapai County, Arizona described below, together with all rights and privileges appurtenant or to become appurtenant to Subject Real Property.

Mining claim AMC368687 (Blue Owl) as filed with the US Department of the Interior, Bureau of Land Management, Phoenix District

Dated this 10th day of March, 2015

GRANTOR:

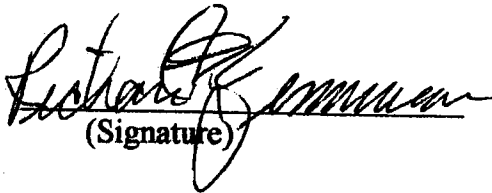
(Signature)

Richard E. Zimmermann,
Manager
Zerad, LLC

PHOENIX, ARIZONA

2015 MAR 17 P 3:03

STATE OF ARIZONA)

) ss.

County of Maricopa)

This instrument was acknowledged before me this 11 th day of March, 2015, by Richard E. Zimmermann.

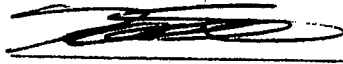

Notary Public

My Commission Expires: 9-07-15

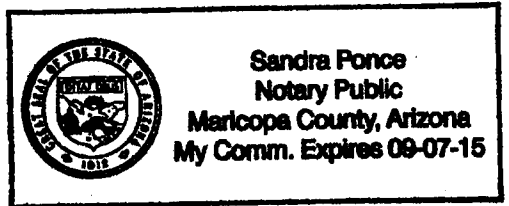

Quit Claim Deed Executed by Richard E. Zimmermann, Manager, Zerad, LLC

ENTERED INTO COMPUTER

3/31/15

425 E Greenway
Drive
Tempe, AZ 85282
March 12, 2014

BLM
Arizona State Office
One North Central Ave. Suite 800
Phoenix, AZ 85004 – 4427

Please transfer ownership of AMC368687 from Zerad LLC to Zeco, Inc. in accordance with the enclosed quit claim deed.

A check is also enclosed for the transfer of interest fee.

Sincerely,

Richard E. Zimmermann

PHOENIX, ARIZONA
2015 MAR 17 P 3:03

United States Department of the Interior
Bureau of Land Management
 LANDS/RECREATION & PLANNING
 ONE N CENTRAL AVE
 PHOENIX, AZ 85004 -2203
 Phone: 602-417-9200

Receipt

No: 3252901

Transaction #: 3348172	
Date of Transaction: 03/18/2015	
CUSTOMER:	
ZERAD INC 425 E GREENWAY DR TEMPE, AZ 85282-6938 US	

LINE #	QTY	DESCRIPTION	REMARKS	UNIT PRICE	TOTAL
1	1.00	LOCATABLE MINERALS / MINING CLAIMS- NOT NEW-UNADJUD, ONE AUTH NO. ONLY / MINING CLAIM MONEY RECEIVED CASES: AMC368687/\$10.00	TRF/1	- n/a -	10.00
TOTAL:					\$10.00

PAYMENT INFORMATION					
1	AMOUNT:	10.00	POSTMARKED:	03/13/2015	
	TYPE:	CHECK	RECEIVED:	03/17/2015	
	CHECK NO:	1620			
	NAME:	ZECO INC 425 E GREENWAY DR TEMPE AZ 85282-6938 US			

REMARKS

This receipt was generated by the automated BLM Collections and Billing System and is a paper representation of a portion of the official electronic record contained therein.

ZIMMERMANN
425 E. Greenway Rd
Tempe, AZ 85282

RECEIVED
BLM AZ STATE OFFICE

2015 MAR 17 P 2:48

PHOENIX, ARIZONA

PHOENIX AZ 852

13 MAR 2015 PM 9 L



Bureau of Land Management
Arizona State Office
One North Central Ave STE 800
Phoenix, AZ 85004 - 4427

85004442700



QUIT CLAIM DEED

THIS QUITCLAIM DEED, Executed this **3rd** Day of **December, 2005**,
by the following party, hereinafter referred to as GRANTORS,

Names: **Ted Bigelow and Sheila Bigelow**

Whose Address is: **P.O. Box 323**

Wittmann, AZ 85361

To second parties, hereinafter referred to as GRANTEES,

Names: **Graham C. and Cherie V. Williams**

Whose Address is: **3325 Mt. McKinley Dr.**

San Jose, CA 95127

PHOENIX, ARIZONA

2005 DEC - 5 P 12: 52

RECEIVED
B.L.M. AZ STATE OFFICE

WITNESSETH, That the said GRANTORS, for good consideration and the sum of Ten Dollars (\$10.00), paid by the GRANTEES, the receipt whereof is hereby acknowledged, does hereby remise, release and quitclaim unto the said GRANTEES forever, all the right, title, interest, and claim which the said GRANTORS has in and to the following described mining claim, and improvements and appurtenances thereto in the County of: **Maricopa** , State of: **Arizona** , to wit:

MINING CLAIM: AMC368388; Thunder Canyon #23

ENTERED IN COMPUTER

12/21/05 MCH

IN WITNESS WHEREOF, The said GRANTORS has signed and sealed these presents the day and year first above written. Signed, sealed and delivered in the presence of:

Name: **Ted Bigelow**

Signature: *Ted Bigelow*

Sheila Bigelow

Signature: *Sheila Bigelow*

STATE OF ARIZONA
COUNTY OF MARICOPA

On 5TH OF DEC. before me, DW CONRAD

Appeared

Personally known to me (or proved to me on the basis of satisfactory evidence) to be the person(s) whose names(s) is/are subscribed to the within instrument and acknowledged to me that he/she/they executed the same in his/her/their authorized capacity(ies), and that by his/her/their signature(s) on the instrument the person(s), or the entity upon behalf of which the person(s) acted, executed the instrument.

WITNESS my hand and official seal.

D.W. Conrad
Signature of Notary

Affiant Known Produced ID
Type of ID A2 DRIVER LICENSE

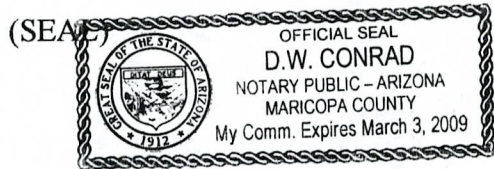

My Commission Expires: MARCH 3, 2009

United States Department of the Interior
Bureau of Land Management
 BUSINESS & SUPPORT SVCS DIV
 ONE N CENTRAL AVE
 PHOENIX, AZ 85004 -2203
 Phone: (602) 417-9200

Receipt	
No:	1195180

Transaction #: 1235428	
Date of Transaction: 12/05/2005	
CUSTOMER:	TED BIGELOW PO BOX 323 WITTMANN,AZ 85361

LINE #	QTY	DESCRIPTION	REMARKS	UNIT PRICE	TOTAL
1	1.00	LOCATABLE MINERALS / MINING CLAIMS-NOT NEW-UNADJUD,ONE AUTH NO. ONLY / MINING CLAIM MONEY RECEIVED (455) CASES: AMC368388/\$20.00	TRF (2)	- n/a -	20.00
TOTAL:					\$20.00

PAYMENT INFORMATION			
1	AMOUNT:	\$20.00	POSTMARKED: N/A
	TYPE:	CASH	RECEIVED: 12/05/2005
	NAME:	BIGELOW, TED PO BOX 323 WITTMANN AZ 85361	

REMARKS

This receipt was generated by the automated BLM Collections and Billing System and is a paper representation of a portion of the official electronic record contained therein.

NOTICE!!

These documents have been scanned!

Do not place un-scanned documents beneath this notice!

Do not remove this notice from this file!

GPO Jacket No. 560-102
Print Order 61540
Rise Business Services, LLC
Job=AZ15 6/3/2019



Box Number= AZ15110



Claim Begin-End: AMC368387-AMC368388

4 Annual Filings



AZ15110-7

AMC367879-AMC368659

DEPARTMENT OF THE INTERIOR
BUREAU OF LAND MANAGEMENT
MINING CLAIMS

Run Date/Time: 8/8/2019

MC Maintenance Fees Paid Through the BLM Pay Portal
(by Date Paid)

Page 13 Of 189

CBS Receipt: 4522542

Printed For Lead File # AMC368387

Agency Tracking ID: 1564701709

Assessment Year: 2020

Number of BLM Serial Nr: 1

Paid On: 8/2/2019

Total Amount Paid: \$330.00

Claim Name	BLM Serial No	Lead File No	Amount Paid
THUNDER CANYON #23	AMC368388	AMC368387	\$330.00

United States Department of the Interior
Bureau of Land Management
 BUSINESS & SUPPORT SVCS DIV
 ONE N CENTRAL AVE SUITE 800
 PHOENIX, AZ 85004 -4427
 Phone: 602-417-9200

Receipt	
No:	4522542

Transaction #: 4643210	
Date of Transaction: 08/01/2019	
CUSTOMER:	
GRAHAM C WILLIAMS 4330 MAJESTIC VIEW PAHRUMP, NV 89060 US	

LINE #	QTY	DESCRIPTION	REMARKS	UNIT PRICE	TOTAL
1	1.00	LOCATABLE MINERALS / MINING CLAIMS- NOT NEW-UNADJUD, ONE AUTH NO. ONLY / MINING CLAIM MONEY RECEIVED CASES: AMC368388/\$330.00		- n/a -	330.00
TOTAL:					\$330.00

PAYMENT INFORMATION			
NOTE: Items will appear on credit card statement as "BLM O Mining Claim".			
1	AMOUNT:	330.00	POSTMARKED: N/A
	TYPE:	CREDIT CARD	RECEIVED: 08/01/2019
	NAME:	GRAHAM C WILLIAMS 4330 MAJESTIC VIEW PAHRUMP NV 89060 US	
	CARD NO:	XXXXXXXXXXXX4138	AUTH CODE: 00149Z
	NAME ON CARD:	GRAHAM C WILLIAMS	
	SIGNATURE:	INTERNET	

REMARKS

This receipt was generated by the automated BLM Collections and Billing System and is a paper representation of a portion of the official electronic record contained therein.

DEPARTMENT OF THE INTERIOR
BUREAU OF LAND MANAGEMENT
MINING CLAIMS

Run Date/Time: 9/24/2020

MC Maintenance Fees Paid Through the BLM Pay Portal
(by Date Paid)

Page 1 Of 1

CBS Receipt: 4772042

Printed For Lead File # AMC368387

Agency Tracking ID: 1596149648

Assessment Year: 2021

Number of BLM Serial Nr: 1

Paid On: 7/30/2020

Total Amount Paid:\$330.00

Message: :

Claim Name	BLM Serial No	Lead File No	Amount Paid
THUNDER CANYON #23	AMC368388	AMC368387	\$330.00

United States Department of the Interior
Bureau of Land Management
 BUSINESS & SUPPORT SVCS DIV
 ONE N CENTRAL AVE SUITE 800
 PHOENIX, AZ 85004 -4427
 Phone: 602-417-9200

Receipt	
No:	4772042

Transaction #: 4898875	
Date of Transaction: 07/30/2020	
CUSTOMER:	
GRAHAM C WILLIAMS 4330 MAJESTIC VW PAHRUMP, NV 89060 US	

LINE #	QTY	DESCRIPTION	REMARKS	UNIT PRICE	TOTAL
1	1.00	LOCATABLE MINERALS / MINING CLAIMS- NOT NEW-UNADJUD, ONE AUTH NO. ONLY / MINING CLAIM MONEY RECEIVED CASES: AMC368388/\$330.00		- n/a -	330.00
TOTAL:					\$330.00

PAYMENT INFORMATION			
NOTE: Items will appear on credit card statement as "BLM O Mining Claim".			
1	AMOUNT:	330.00	POSTMARKED: N/A
	TYPE:	CREDIT CARD	RECEIVED: 07/30/2020
	NAME:	GRAHAM C WILLIAMS 4330 MAJESTIC VW PAHRUMP NV 89060 US	
	CARD NO:	XXXXXXXXXXXX1605	AUTH CODE: 006645
	NAME ON CARD:	GRAHAM C WILLIAMS	
	SIGNATURE:	INTERNET	

REMARKS

This receipt was generated by the automated BLM Collections and Billing System and is a paper representation of a portion of the official electronic record contained therein.

DEPARTMENT OF THE INTERIOR
BUREAU OF LAND MANAGEMENT
MINING CLAIMS

Run Date/Time: 8/20/2018

MC Maintenance Fees Paid Through the BLM Pay Portal
(by Date Paid)

Page 137 Of 316

CBS Receipt: 4232750

Printed For Lead File # AMC368387

Agency Tracking ID: 1534005524

Assessment Year: 2019

Paid On: 8/11/2018

Number of BLM Serial Nr: 1

Total Amount Paid: \$310.00

Claim Name	BLM Serial No	Lead File No	Amount Paid
THUNDER CANYON #23	AMC368388	AMC368387	\$310.00

United States Department of the Interior
Bureau of Land Management
 BUSINESS & SUPPORT SVCS DIV
 ONE N CENTRAL AVE SUITE 800
 PHOENIX, AZ 85004 -4427
 Phone: 602-417-9200

Receipt

No: 4232750

Transaction #: 4348061	
Date of Transaction: 08/11/2018	
CUSTOMER:	
GRAHAM C WILLIAMS 4330 MAJESTIC VIEW PAHRUMP, NV 89060 US	

LINE #	QTY	DESCRIPTION	REMARKS	UNIT PRICE	TOTAL
1	1.00	LOCATABLE MINERALS / MINING CLAIMS- NOT NEW-UNADJUD, ONE AUTH NO. ONLY / MINING CLAIM MONEY RECEIVED CASES: AMC368388/\$310.00		- n/a -	310.00
TOTAL:					\$310.00

PAYMENT INFORMATION					
NOTE: Items will appear on credit card statement as "BLM O Mining Claim".					
1	AMOUNT:	310.00	POSTMARKED:	N/A	
	TYPE:	CREDIT CARD	RECEIVED:	08/11/2018	
	NAME:	GRAHAM C WILLIAMS 4330 MAJESTIC VIEW PAHRUMP NV 89060 US			
	CARD NO:	XXXXXXXXXXXX3791	AUTH CODE:	01132Z	
	NAME ON CARD:	GRAHAM C WILLIAMS			
	SIGNATURE:				

REMARKS

This receipt was generated by the automated BLM Collections and Billing System and is a paper representation of a portion of the official electronic record contained therein.

Run Date: 08/25/16

Run Time: 05:50 AM

**DEPARTMENT OF THE INTERIOR
BUREAU OF LAND MANAGEMENT
MINING CLAIMS**

MC Maintenance Fees Paid Through the BLM Pay Portal

CBS Receipt: 3629514

Printed For Lead File # **AMC368387**

Agency Tracking ID: 1471041278

Assessment Year: 2017

Number of BLM Serial Nr: 1

Paid On: 08/12/2016

Total Amount Paid: \$310.00

Claim Name	BLM Serial No	Lead File No	Amount Paid
THUNDER CANYON #23	AMC368388	AMC368387	\$310.00

**United States Department of the Interior
Bureau of Land Management
BUSINESS & SUPPORT SVCS DIV
ONE N CENTRAL AVE SUITE 800
PHOENIX, AZ 85004 -4427
Phone: (602) 417-9200**

Receipt

No: 3629514

Transaction #: 3733292	
Date of Transaction: 08/12/2016	
CUSTOMER:	
GRAHAM C WILLIAMS 3325 MT. MCKINLEY DR SAN JOSE, CA 95127 US	

LINE #	QTY	DESCRIPTION	REMARKS	UNIT PRICE	TOTAL
1	1.00	LOCATABLE MINERALS / MINING CLAIMS- NOT NEW-UNADJUD, ONE AUTH NO. ONLY / MINING CLAIM MONEY RECEIVED CASES: AMC368388/\$310.00		- n/a -	310.00
TOTAL:					\$310.00

PAYMENT INFORMATION			
NOTE: Items will appear on credit card statement as "BLM O Mining Claim".			
1	AMOUNT:	310.00	POSTMARKED: N/A
	TYPE:	CREDIT CARD	RECEIVED: 08/12/2016
	NAME:	GRAHAM C WILLIAMS 3325 MT. MCKINLEY DR SAN JOSE CA 95127 US	
	CARD NO:	XXXXXXXXXXXX3791	AUTH CODE: 01246Z
	NAME ON CARD:	GRAHAM C WILLIAMS	
	EXPIRES:	06/2018	
	SIGNATURE:		

REMARKS

This receipt was generated by the automated BLM Collections and Billing System and is a paper representation of a portion of the official electronic record contained therein.

United States Department of the Interior
Bureau of Land Management
 BUSINESS & SUPPORT SVCS DIV
 ONE N CENTRAL AVE SUITE 800
 PHOENIX, AZ 85004 -4427
 Phone: (602) 417-9200

Receipt

No: 3359888

Transaction #: 3457871	
Date of Transaction: 08/05/2015	
CUSTOMER:	
GRAHAM C. WILLIAMS 3325 MT. MCKINLEY DR. SAN JOSE, CA 95127 US	

LINE #	QTY	DESCRIPTION	REMARKS	UNIT PRICE	TOTAL
1	1.00	LOCATABLE MINERALS / MINING CLAIMS- NOT NEW-UNADJUD, ONE AUTH NO. ONLY / MINING CLAIM MONEY RECEIVED CASES: AMC368388/\$310.00		- n/a -	310.00
TOTAL:					\$310.00

PAYMENT INFORMATION			
NOTE: Items will appear on credit card statement as "BLM O Mining Claim".			
1	AMOUNT:	310.00	POSTMARKED: N/A
	TYPE:	CREDIT CARD	RECEIVED: 08/05/2015
	NAME:	GRAHAM C. WILLIAMS 3325 MT. MCKINLEY DR. SAN JOSE CA 95127 US	
	CARD NO:	XXXXXXXXXXXX7352	AUTH CODE: 00526Z
	NAME ON CARD:	GRAHAM C. WILLIAMS	
	EXPIRES:	01/2017	
	SIGNATURE:		

REMARKS

This receipt was generated by the automated BLM Collections and Billing System and is a paper representation of a portion of the official electronic record contained therein.

Run Date: 08/12/15

Run Time: 08:37 AM

**DEPARTMENT OF THE INTERIOR
BUREAU OF LAND MANAGEMENT
MINING CLAIMS**

MC Maintenance Fees Paid Through the BLM Pay Portal

CBS Receipt: 3359888

Printed For Lead File # AMC368387

Agency Tracking ID: 1438813998

Assessment Year: 2016

Number of BLM Serial Nr: 1

Paid On: 08/05/2015

Total Amount Paid: \$310.00

Claim Name	BLM Serial No	Lead File No	Amount Paid
THUNDER CANYON #23	AMC368388	AMC368387	\$310.00

Run Date: 08/20/14

41

Run Time: 03:40 PM

368387

**DEPARTMENT OF THE INTERIOR
BUREAU OF LAND MANAGEMENT
MINING CLAIMS**

MC Maintenance Fees Paid Through the BLM Pay Portal

CBS Receipt: 3105069

Agency Tracking ID: 98970693

Assessment Year: 2015

Paid On : 08/18/2014

Number of BLM Serial Nr: 1

Total Amount Paid: \$310.00

Claim Name	BLM Serial No	Lead File No	Case Type	Amount Paid
THUNDER CANYON #23	AMC368388	AMC368387	384201	\$310.00

United States Department of the Interior
Bureau of Land Management
 BUSINESS & SUPPORT SVCS DIV
 ONE N CENTRAL AVE SUITE 800
 PHOENIX, AZ 85004 -4427
 Phone: (602) 417-9200

Receipt

No: 3105069

Transaction #: 3196676	
Date of Transaction: 08/18/2014	
CUSTOMER:	
GRAHAM C WILLIAMS 3325 MOUNT MCKINLEY DR SAN JOSE,CA 95127	

LINE #	QTY	DESCRIPTION	REMARKS	UNIT PRICE	TOTAL
1	1.00	LOCATABLE MINERALS / MINING CLAIMS- NOT NEW-UNADJUD,ONE AUTH NO. ONLY / MINING CLAIM MONEY RECEIVED CASES: AMC368388/\$310.00		- n/a -	310.00
TOTAL:					\$310.00

PAYMENT INFORMATION			
NOTE: Items will appear on credit card statement as "BLM O Mining Claim".			
1	AMOUNT:	310.00	POSTMARKED: N/A
	TYPE:	CREDIT CARD	RECEIVED: 08/18/2014
	NAME:	GRAHAM C WILLIAMS 3325 MOUNT MCKINLEY DR SAN JOSE CA 95127	
	CARD NO:	XXXXXXXXXXXX2827	AUTH CODE: 01824Z
	NAME ON CARD:	GRAHAM C WILLIAMS	
	EXPIRES:	06/2015	
	SIGNATURE:		

REMARKS

This receipt was generated by the automated BLM Collections and Billing System and is a paper representation of a portion of the official electronic record contained therein.

UNITED STATES
DEPARTMENT OF THE INTERIOR
BUREAU OF LAND MANAGEMENT

AMC 368387

CREDIT CARD PAYMENT
For Mining Claim Maintenance Fee

THIS IS A CHANGE OF ADDRESS

TELEPHONE SUBMISSION - ACCURACY OF THE BELOW INFORMATION IS THE RESPONSIBILITY OF THE CLAIMANT/OWNER

NAME Graham C. Williams
ADDRESS 3325 Mount McKinley Dr.
CITY San Jose STATE CA ZIP 95127
PHONE # 408 - 272 8139

SEND RECEIPT TO Above address
 Other (Include Name and Mailing Address):

AMC NUMBER

368388

CLAIM/SITE NAME

Thunder Canyon #23 - 40 acres

1 # of Claim/Site
x 140.00 Each
\$ 280 Total Charged MCW (INITIALS)

RECEIPT # 2856707

DATE STAMP

RECEIVED
BLM AZ STATE OFFICE
PHOENIX, ARIZONA
2013 AUG -8 P 3:27

**** FOR OFFICIAL USE ONLY ****

ENTERED INTO COMPUTER

DATE _____

INITIALS _____

VERIFIED AUG 14 2013

TS

**United States Department of the Interior
Bureau of Land Management
LANDS/RECREATION & PLANNING
ONE N CENTRAL AVE
PHOENIX, AZ 85004 -2203
Phone: 602-417-9200**

Receipt

No: 2850707

Transaction #: 2936438	
Date of Transaction: 08/08/2013	
CUSTOMER:	
GRAHAM C WILLIAMS 3325 MOUNT MCKINLEY DR SAN JOSE, CA 95127-4808 US	

LINE #	QTY	DESCRIPTION	REMARKS	UNIT PRICE	TOTAL
1	1.00	LOCATABLE MINERALS / MINING CLAIMS- NOT NEW-UNADJUD, ONE AUTH NO. ONLY / MINING CLAIM MONEY RECEIVED CASES: AMC368388/\$280.00	MAINT 2014/1	- n/a -	280.00
TOTAL:					\$280.00

PAYMENT INFORMATION					
NOTE: Items will appear on credit card statement as "Bureau of Land Mgmt CO".					
1	AMOUNT:	280.00	POSTMARKED:	N/A	
	TYPE:	CREDIT CARD	RECEIVED:	08/08/2013	
	NAME:	WILLIAMS, GRAHAM C 3325 MOUNT MCKINLEY DR SAN JOSE CA 95127-4808 US			
	CARD NO:	XXXXXXXXXXXX2827	AUTH CODE:	008420	
	NAME ON CARD:	GRAHAM C WILLIAMS			
	EXPIRES:	06/2015			
	SIGNATURE:				

REMARKS

This receipt was generated by the automated BLM Collections and Billing System and is a paper representation of a portion of the official electronic record contained therein.

Amc 368387

90-7683 27 1724
3211

CHERIE V. WILLIAMS
GRAHAM C. WILLIAMS
3325 MT MC KINLEY DR. 408-272-8139
SAN JOSE, CA 95127

DATE 8/5/12

Pay to the order of BLM \$280.00

Two - Hundred Eighty and 00/100 DOLLARS

40 ACRES MERIWEST thunder canyon #23

CREDIT UNION
5615 Chesbro, San Jose, CA 95123

AMC 368388

John C. Williams



Graham Williams
3325 Mount McKinley Dr.
San Jose, CA 95127

SAN JOSE CA 95127



RECEIVED
BLM AZ STATE OFFICE

2012 AUG -9 P 3:15

PHOENIX, ARIZONA

BLM
1 North Central Ave,
Suite 800
Phoenix, AZ 85004

85004442700

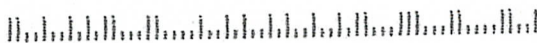

NO. OF CLAIMS 1
AMOUNT \$280.00
RECEIPT NO. 2627706
INIT. A.H.

40 acres

** BLM-ASO **

ENTERED INTO COMPUTER

8/22/12 AT



Graham Williams
3325 Mount McKinley Dr.
San Jose, CA 95127

SAN JOSE CA 950

08 AUG 2012 PM 2 1



Justice
FOREVER

2108

RECEIVED
BLM AZ STATE OFFICE

2012 AUG -9 P 3:15

PHOENIX, ARIZONA

BLM

1 North Central Ave,
Suite 800

Phoenix, AZ 85004

85004442700





Graham Williams
3325 Mount McKinley Dr.
San Jose, CA 95127

SAN JOSE CA 9500

06 AUG 2012 PMZ L



RECEIVED
BLM AZ STATE OFFICE

2012 AUG -9 P 3:15

PHOENIX, ARIZONA

BLM
North Central Ave,
Suite 800
Phoenix, AZ 85004

00004442700

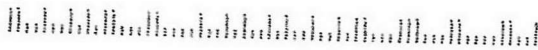

United States Department of the Interior
Bureau of Land Management
 LANDS/RECREATION & PLANNING
 ONE N CENTRAL AVE
 PHOENIX, AZ 85004 -2203
 Phone: 602-417-9200

Receipt

No: 2627206

Transaction #: 2707652	
Date of Transaction: 08/10/2012	
CUSTOMER:	
GRAHAM C WILLIAMS 3325 MOUNT MCKINLEY DR SAN JOSE, CA 95127-4808 US	

LINE #	QTY	DESCRIPTION	REMARKS	UNIT PRICE	TOTAL
1	1.00	LOCATABLE MINERALS / MINING CLAIMS-NOT NEW-UNADJUD, ONE AUTH NO. ONLY / MINING CLAIM MONEY RECEIVED CASES: AMC368388/\$280.00	MAINT FEE PYMNT (1) 2013	- n/a -	280.00
TOTAL:					\$280.00

PAYMENT INFORMATION			
1	AMOUNT:	280.00	POSTMARKED: 08/06/2012
	TYPE:	CHECK	RECEIVED: 08/10/2012
	CHECK NO:	1724	
	NAME:	WILLIAMS, GRAHAM C 3325 MOUNT MCKINLEY DR SAN JOSE CA 95127-4808 US	

REMARKS

This receipt was generated by the automated BLM Collections and Billing System and is a paper representation of a portion of the official electronic record contained therein.

UNITED STATES
DEPARTMENT OF THE INTERIOR
BUREAU OF LAND MANAGEMENT

AMC 368387

CREDIT CARD PAYMENT
For Mining Claim Maintenance Fee

THIS IS A CHANGE OF ADDRESS

TELEPHONE SUBMISSION - ACCURACY OF THE BELOW INFORMATION IS THE RESPONSIBILITY OF THE CLAIMANT/OWNER

NAME Graham C. Williams
ADDRESS 3325 Mount McKinley Dr
CITY San Jose STATE CA ZIP 95127
PHONE # 408 - 272-8139

SEND RECEIPT TO Above address
 Other (Include Name and Mailing Address):

AMC NUMBER
368388

CLAIM/SITE NAME
Thunder Canyon #23

1 # of Claim/Site
x 140.00 Each
\$ 140.00 Total Charged _____ (INITIALS)

RECEIPT # 2404862

DATE STAMP

RECEIVED
BLM AZ STATE OFFICE
2011 AUG 15 A 11:10
PHOENIX, ARIZONA

***** FOR OFFICIAL USE ONLY *****
DATE _____ INITIALS _____ VERIFIED _____
AUG 23 2011 Cm

United States Department of the Interior
Bureau of Land Management
 LANDS/RECREATION & PLANNING
 ONE N CENTRAL AVE
 PHOENIX, AZ 85004 -2203
 Phone: 602-417-9200

Receipt

No: 2404862

Transaction #: 2480113	
Date of Transaction: 08/15/2011	
CUSTOMER:	
GRAHAM C WILLIAMS 3325 MOUNT MCKINLEY DR SAN JOSE, CA 95127-4808 US	

LINE #	QTY	DESCRIPTION	REMARKS	UNIT PRICE	TOTAL
1	1.00	LOCATABLE MINERALS / MINING CLAIMS- NOT NEW-UNADJUD, ONE AUTH NO. ONLY / MINING CLAIM MONEY RECEIVED CASES: AMC368388/\$140.00	2012 MAINT (1)	- n/a -	140.00
TOTAL:					\$140.00

PAYMENT INFORMATION			
NOTE: Items will appear on credit card statement as "Bureau of Land Mgmt CO".			
1	AMOUNT:	140.00	POSTMARKED: N/A
	TYPE:	CREDIT CARD	RECEIVED: 08/15/2011
	NAME:	WILLIAMS, GRAHAM C 3325 MOUNT MCKINLEY DR SAN JOSE CA 95127-4808 US	
	CARD NO:	XXXXXXXXXXXX2827	AUTH CODE: 015768
	NAME ON CARD:	GRAHAM C WILLIAMS	
	EXPIRES:	06/2013	
	SIGNATURE:		

REMARKS

This receipt was generated by the automated BLM Collections and Billing System and is a paper representation of a portion of the official electronic record contained therein.

AMC 368387

UNITED STATES
DEPARTMENT OF THE INTERIOR
BUREAU OF LAND MANAGEMENT

CREDIT CARD PAYMENT
For Mining Claim Maintenance Fee

THIS IS A CHANGE OF ADDRESS

TELEPHONE SUBMISSION - ACCURACY OF THE BELOW INFORMATION IS THE RESPONSIBILITY OF THE CLAIMANT/OWNER

NAME Graham WILLIAMS
ADDRESS 3325 Mt McKinley DR
CITY San Jose STATE CA ZIP 95127-4808
PHONE # 408 - 272-8139

SEND RECEIPT TO Above address
 Other (Include Name and Mailing Address):

AMC NUMBER
368388

CLAIM/SITE NAME
Thunder Canyon #23

ENTERED INTO COMPUTER mt AUG 19 2010

1 # of Claim/Site
x 140.00 Each
\$ 140 Total Charged EG (INITIALS)

RECEIPT # 2189583

DATE STAMP

RECEIVED
BLM AZ STATE OFFICE
2010 AUG 12 P 12:02
PHOENIX, ARIZONA

***** FOR OFFICIAL USE ONLY *****
DATE _____ INITIALS _____ VERIFIED _____

United States Department of the Interior
Bureau of Land Management
 LANDS/RECREATION & PLANNING
 ONE N CENTRAL AVE
 PHOENIX, AZ 85004 -2203
 Phone:

Receipt

No: 2189583

Transaction #: 2259298		ENTERED INTO COMPUTER
Date of Transaction: 08/12/2010		
CUSTOMER:	GRAHAM C WILLIAMS 3325 MOUNT MCKINLEY DR SAN JOSE, CA 95127-4808 US	<i>W/C</i> AUG 19 2010

LINE #	QTY	DESCRIPTION	REMARKS	UNIT PRICE	TOTAL
1	1.00	LOCATABLE MINERALS / MINING CLAIMS- NOT NEW-UNADJUD, ONE AUTH NO. ONLY / MINING CLAIM MONEY RECEIVED CASES: AMC368388/\$140.00	2011 MAINT (1)	- n/a -	140.00
TOTAL:					\$140.00

PAYMENT INFORMATION			
NOTE: Items will appear on credit card statement as "Bureau of Land Mgmt CO".			
1	AMOUNT:	140.00	POSTMARKED: N/A
	TYPE:	CREDIT CARD	RECEIVED: 08/12/2010
	NAME:	WILLIAMS, GRAHAM C 3325 MOUNT MCKINLEY DR SAN JOSE CA 95127-4808 US	
	CARD NO:	XXXXXXXXXXXX2827	AUTH CODE: 012388
	NAME ON CARD:	GRAHAM WILLIAMS	
	EXPIRES:	06/2011	
	SIGNATURE:		

REMARKS

This receipt was generated by the automated BLM Collections and Billing System and is a paper representation of a portion of the official electronic record contained therein.

SENDER: COMPLETE THIS SECTION

- Complete items 1, 2, and 3. Also complete Item 4 if Restricted Delivery is desired.
- Print your name and address on the reverse so that we can return the card to you.
- Attach this card to the back of the mailpiece, or on the front if space permits.

1. Article Addressed to:

George & Joan Bernier
5662 Vinevale Circle
La Palma, California 90623
AZ931 TS AMC367671,
AMC368387, AMC381023

COMPLETE THIS SECTION ON DELIVERY

A. Signature Agent
 Joan Bernier Addressee

B. Received by (Printed Name) C. Date of Delivery
5/29

D. Is delivery address different from item 1? Yes
If YES, enter delivery address below: No

3. Service Type
 Certified Mail Express Mail
 Registered Return Receipt for Merchandise
 Insured Mail C.O.D.

4. Restricted Delivery? (Extra Fee) Yes

2. Article Number
(Transfer from service label)

7009 1410 0001 7124 5224

AMC 368387
381023
367671

MAINTENANCE FEE PAYMENT

Claimant Name: GEORGE BERNIER
 Address: 5662 VINEVALE CIRCLE
 City: LAPALMA State: CA Zip: 90623
 Telephone: 714-995-3815
 E-mail address: DRGWB1@AOL.COM
 Signature: *George Bernier*

RECEIVED
BLMAZ STATE OFFICE
2009 AUG - 3 A 8: 29
PHOENIX, ARIZONA
BLM
Date
Stamp

Check here if this is a change of address.

LINE NO.	AMC NUMBER	CLAIM/SITE NAME	COUNTY RECORDER DATA (If available)	TWP	RNG	SEC
1	381024	THUNDER CANYON	MARICOPA 07-0484401	7N	4W	25
2	367671	RAINBOW'S END #5	MARICOPA 05-1552881	7N	3W	7
3	368387	RAINBOW'S END #8	05-1760761 (MARICOPA) 39667988-4355 P-885 (YAVAPAI)	7N	3W	8
4						
5						
6						
7						
8						
9						
10						

List additional claims on Form MCF114.

Bureau of Land Management
Arizona State Office
www.blm.gov/az/

No. of Claims: 3 x \$140 = 420.00
 Check No: 3150 Init. *SMG*
 Receipt No.: 1971072
 For BLM Use Only

Form: MCF112
Revised July 2009

This form is available from the Arizona Department of Mines and Mineral Resources and may be reproduced.

ENTERED INTO COMPUTER
8/20/09 *DDG*

United States Department of the Interior

Bureau of Land Management
 BUSINESS & SUPPORT SVCS DIV
 ONE N CENTRAL AVE SUITE 800
 PHOENIX, AZ 85004 -4427
 Phone: (602) 417-9200

Receipt

No: 1971072

Transaction #: 2034942	
Date of Transaction: 08/05/2009	
CUSTOMER:	GEORGE W BERNIER 5662 VINEVALE CIR LA PALMA,CA 90623-2114 US

LINE #	QTY	DESCRIPTION	REMARKS	UNIT PRICE	TOTAL
1	1.00	LOCATABLE MINERALS / MINING CLAIMS-NOT NEW-UNADJUD,ONE AUTH NO. ONLY / MINING CLAIM MONEY RECEIVED CASES: AMC381024/\$420.00	MAINT 2010	- n/a -	420.00
TOTAL:					\$420.00

PAYMENT INFORMATION					
1	AMOUNT:	420.00	POSTMARKED:	07/30/2009	
	TYPE:	CHECK	RECEIVED:	08/03/2009	
	CHECK NO:	3150			
	NAME:	BERNIER, GEORGE W 5662 VINEVALE CIR LA PALMA CA 90623-2114 US			

REMARKS

This receipt was generated by the automated BLM Collections and Billing System and is a paper representation of a portion of the official electronic record contained therein.

AMC 368387

UNITED STATES
DEPARTMENT OF THE INTERIOR
BUREAU OF LAND MANAGEMENT

CREDIT CARD PAYMENT
For Mining Claim Maintenance Fee

THIS IS A CHANGE OF ADDRESS

TELEPHONE SUBMISSION - ACCURACY OF THE BELOW INFORMATION IS THE RESPONSIBILITY OF THE CLAIMANT/OWNER

NAME Graham C. Williams
ADDRESS 3325 Mountain McKinley
CITY San Jose STATE CA ZIP 95127
PHONE # 408 - 272-8139

SEND RECEIPT TO Above address
 Other (Include Name and Mailing Address):

AMC NUMBER
368388

CLAIM/SITE NAME
Under Canyon #23

1 # of Claim/Site
~~x140. 125.00~~ Each
\$ 140.00 Total Charged AH (INITIALS)

RECEIVED
BLM AZ STATE OFFICE
JUL 10 P 1:28
TUCSON, ARIZONA

***** FOR OFFICIAL USE ONLY *****
DATE _____ INITIALS _____ VERIFIED _____

ENTERED INTO COMPUTER
7/23/09 [Signature]

United States Department of the Interior
Bureau of Land Management
 BUSINESS & SUPPORT SVCS DIV
 ONE N CENTRAL AVE SUITE 800
 PHOENIX, AZ 85004 -4427
 Phone: (602) 417-9200

Receipt

No: 1955149

Transaction #: 2018758	
Date of Transaction: 07/10/2009	
CUSTOMER:	GRAHAM C WILLIAMS 3325 MOUNT MCKINLEY DR SAN JOSE,CA 95127-4808 US

LINE #	QTY	DESCRIPTION	REMARKS	UNIT PRICE	TOTAL
1	1.00	LOCATABLE MINERALS / MINING CLAIMS- NOT NEW-UNADJUD,ONE AUTH NO. ONLY / MINING CLAIM MONEY RECEIVED CASES: AMC368388/\$140.00	2010 MAINT (1)	- n/a -	140.00
TOTAL:					\$140.00

PAYMENT INFORMATION			
NOTE: Items will appear on credit card statement as "Bureau of Land Mgmt CO".			
1	AMOUNT:	140.00	POSTMARKED: N/A
	TYPE:	CREDIT CARD	RECEIVED: 07/10/2009
	NAME:	WILLIAMS, GRAHAM C 3325 MOUNT MCKINLEY DR SAN JOSE CA 95127-4808 US	
	CARD NO:	XXXXXXXXXXXX2827	AUTH CODE: 010397
	NAME ON CARD:	GRAHAM C WILLIAMS	
	EXPIRES:	06/2011	
	SIGNATURE:		

REMARKS

This receipt was generated by the automated BLM Collections and Billing System and is a paper representation of a portion of the official electronic record contained therein.

When Recorded Return Document to:

GEORGE BERNIER
5662 VINEVALE CIRCLE
LAPALMA, CA 90623

AMC 368387

Check here is this is a change of address.

Telephone: 714-995-3815

E-mail address: DRGWB1@ADL.COM

AFFIDAVIT OF PERFORMANCE OF ANNUAL WORK

1. State of Arizona, County of MARICOPA/YAVAPAI ss:

2. I (Name) GEORGE BERNIER

3. Reside at (Address) 5662 VINEVALE CIRCLE

City LA PALMA County ORANGE

RECEIVED
BLM AZ STATE OFFICE
2008 NOV 26 A 10: 06
PHOENIX, ARIZONA
BLM
Date
Stamp

State CA Zip 90623 being duly sworn, depose and say that I am a citizen of the United States, more than eighteen years of age, and that all of the facts set forth in this affidavit, subject to the provisions and penalties of 18 U.S.C. 1001 pertaining to the filing of false, fictitious, or fraudulent statements with the United States, are true and correct according to the best of my knowledge, information and belief.

4. Owner's name and address (If not shown in Items 1-3 above).

5. That I am personally acquainted with the mining claim(s). The work and improvements were made by and at the expense of the owner(s) of said claim(s). Said contiguous group of claims, listed on this document, are situated in the

SAN DOMINGO (optional) Mining District; MARICOPA/YAVAPAI County, Arizona.

Line No.	AMC NUMBER	CLAIM/SITE NAME	COUNTY RECORDER DATA (If available)	TWP	RNG	SEC
1	368387	RAINBOWS END # 8	05-1760761 (MARICOPA) 3966798 B-4355 P-885 (YAVAPAI)	7N	3W	8
2						
3						
4						
5						
6						

Form: MCF108
Revised Jan. 2006
Page 1 of 2

RE 1/12/09
ENTERED IN COMPUTER

RECEIVED
BLM AZ STATE OFFICE
2008 NOV 26 A 10: 01
PHOENIX, ARIZONA

BLM
Date
Stamp

7						
8						
9						
10						

6. That between the dates starting at 12 o'clock noon on September 1, 20 07 and ending at 12 o'clock noon on September 1, 20 08 at least \$ 100.00 dollars worth of work and improvements were done and performed upon said claim(s) or upon one or more of a contiguous group of claims for the benefit of all, wholly or partly outside of a contiguous group of claims for the benefit of all, not including the location work.

7. That the following persons were employed to perform the work and improvements described herein: MYSELF

8. That the work and improvements performed were: MINING, ROAD IMPROVEMENTS, EXPLORATION, RECLAMATION

9. Dated: 11-21-08 Signature: George W. Bernier

SUBSCRIBED AND SWORN TO before me, a Notary Public, this 21ST day of November 2008

By: GEORGE WILLIAM BERNIER

Notary Public [Signature]

My Commission Expires 09-09-2009



Bureau of Land Management
Arizona State Office
www.az.blm.gov

No. of Claims: 1 x \$10 = 10.00
 Check No.: 2645 Init. SPB
 Receipt No.: 1826197
 For BLM Use Only

Form: MCF108
Revised Jan. 2006
Page 2 of 2

United States Department of the Interior
Bureau of Land Management
 BUSINESS & SUPPORT SVCS DIV
 ONE N CENTRAL AVE SUITE 800
 PHOENIX, AZ 85004 -4427
 Phone: (602) 417-9200

Receipt

No: 1826192

Transaction #: 1885188	
Date of Transaction: 11/26/2008	
CUSTOMER:	GEORGE W BERNIER 5662 VINEVALE CIR LA PALMA,CA 90623-2114 US

LINE #	QTY	DESCRIPTION	REMARKS	UNIT PRICE	TOTAL
1	1.00	LOCATABLE MINERALS / MINING CLAIMS-NOT NEW-UNADJUD,ONE AUTH NO. ONLY / MINING CLAIM MONEY RECEIVED CASES: AMC368387/\$10.00	POL	- n/a -	10.00
TOTAL:					\$10.00

PAYMENT INFORMATION					
1	AMOUNT:	10.00	POSTMARKED:	11/24/2008	
	TYPE:	CHECK	RECEIVED:	11/26/2008	
	CHECK NO:	2645			
	NAME:	BERNIER, GEORGE W 5662 VINEVALE CIR LA PALMA CA 90623-2114 US			

REMARKS

This receipt was generated by the automated BLM Collections and Billing System and is a paper representation of a portion of the official electronic record contained therein.

UNITED STATES DEPARTMENT OF THE INTERIOR
BUREAU OF LAND MANAGEMENT

114

Amc 367671
Amc 368387
Amc 381023

FORM APPROVED
OMB NO. 1004-0114
Expires: February 28, 2010

MAINTENANCE FEE WAIVER CERTIFICATION

SEE INSTRUCTIONS ON REVERSE

PS

1. This small miner waiver is filed for the assessment year beginning at noon on September 1, ~~2007~~ and ending at noon on September 1, ~~2008~~
2. The undersigned and all related parties owned ten or fewer mining claims, mill, or tunnel sites located and maintained on Federal lands in the United States of America on September 1, ~~2008~~
3. The undersigned have performed the assessment work required by law for each mining claim listed prior to filing this waiver and understand that by filing this form; an affidavit of assessment work must be recorded by the December 30th following the filing of this waiver.
4. The undersigned understand that if the assessment work obligation has not yet come due under 30 U.S.C. 28 (for those claims in their first assessment year only); a notice of intent to hold reciting this condition must be recorded by the December 30th following the filing of this waiver.
5. The undersigned understand that mill and tunnel sites may also be listed upon this waiver and be waived from payment of the maintenance fee; and that a notice of intent to hold for these sites is required to be recorded by the December 30th immediately following the filing of this waiver.
6. The undersigned understand and acknowledge that pursuant to 43 U.S.C. 1212 and 18 U.S.C. 1001; the filing or recording of a false, fictitious, or fraudulent document with the Bureau of Land Management may result in a fine of up to \$250,000, a prison term not to exceed five years, or both.
7. The mining claims, mill or tunnel sites for which this waiver from payment of the maintenance fees is requested are:

CLAIM OR SITE NAME	BLM RECORDATION SERIAL NUMBER
1. RAINBOW'S END #5	AMC 367671
2. RAINBOW'S END #8	AMC 368387
3. THUNDER CANYON	AMC 381024
4.	
5.	
6.	
7.	
8.	
9.	
10.	

The owner(s) (claimants) of the above mining claims and sites are:

GEORGE BERNIER
(Owner's Name - Please Print)
5662 VINEVALE CIRCLE
(Street or P.O. Box)
LA PALMA CA 90623
(City) (State) (Zip Code)

George W. Bernier
(Owner's Signature)

JOAN BERNIER
(Owner's Name - Please Print)
5662 VINEVALE CIRCLE
(Street or P.O. Box)
LA PALMA CA 90623
(City) (State) (Zip Code)

Joan M. Bernier
(Owner's Signature)

(Owner's Name - Please Print)

(Street or P.O. Box)

(City) (State) (Zip Code)

(Owner's Signature)

(Continued on page 2)

ENTERED INTO COMPUTER
9/8/08 AB

(Owner's Name - Please Print)	(Owner's Signature)
(Street or P.O. Box)	(City) (State) (Zip Code)
(Owner's Name - Please Print)	(Owner's Signature)
(Street or P.O. Box)	(City) (State) (Zip Code)
(Owner's Name - Please Print)	(Owner's Signature)
(Street or P.O. Box)	(City) (State) (Zip Code)
(Owner's Name - Please Print)	(Owner's Signature)
(Street or P.O. Box)	(City) (State) (Zip Code)

INSTRUCTIONS

1. This certification is made under the provisions of § 1744 of Title 43 and § 28-28k of Title 30 of the United States Code; and the regulations thereunder (43 CFR Part 3830).
2. The claimant(s) must fill in the dates in paragraph 1 for the beginning and ending of the assessment year for which this waiver is sought.
3. The claimant(s) must fill in the date in paragraph 2 for the beginning of the assessment year for which this waiver is sought.
4. All claim and site names and Bureau of Land Management (BLM) serial numbers must be listed for the mining claims, mill sites, and tunnel sites for which the waiver is sought.
5. All owners of the mining claims, mill sites, and tunnel sites and their addresses must be given.
6. This waiver form must be signed by all the claimants or their designated agent, in original form. If an agent is designated, a notarized designation of agent, signed by all of the claimants with proper address given, must be submitted with this waiver.
7. This form must be filed no later than September 1st for the upcoming assessment year in the BLM State Office where the mining claims or sites are recorded, or the waiver cannot be granted by the BLM. (Example: to obtain a waiver for the assessment year 2000, which begins at noon on September 1, 1999, you must qualify for and file for a waiver no later than September 1, 1999, in the proper BLM State Office).
8. For all mining claims which require assessment work, you must record an affidavit of labor on or before the December 30th immediately following the filing of this waiver. For all other mining claims or sites waived, you must record a notice of intent to hold on or before the December 30th immediately following the filing of this waiver.
9. Mill and tunnel sites may also be listed upon this waiver and be waived from payment of the maintenance fee. A notice of intent to hold for these sites is required to be filed by the December 30th following the filing of this waiver.

NOTICE/BURDEN HOURS STATEMENT

The Privacy Act of 1974, as amended, and the regulation in 43 CFR 2.48(d) provide that you be furnished the following information in connection with the information required by this certification of waiver from rental fees.

AUTHORITY: 30 U.S.C. 28-28k; 43 U.S.C. 1201, 1457, 1740, and 1744; and 43 CFR 3830.

PRINCIPLE PURPOSE: This information is to be used to verify that the owner(s) (claimants) of a mining claim has complied with 30 U.S.C. 28f and is entitled to perform assessment work in lieu of paying the maintenance fee for the mining claims listed on this form.

ROUTINE USE: (1) Adjudication of the claimant(s) certification of waiver from paying the maintenance fee otherwise required by 30 U.S.C. 28f. (2) Disclosure may be made to appropriate Federal agencies when location is made within the agency's geographic area of responsibility. (3) Information from the record and/or the record will be transferred to the appropriate Federal, State, or local agency, or a member of the public in response to a specific request for pertinent information. (4) Information may also be provided to the Department of Justice or in a proceeding before a court or adjudicative body; or to Federal, State, local or foreign agencies when needed for enforcement of civil or criminal codes or applicable regulations concerning title rights upon the public land.

EFFECT OF NOT PROVIDING INFORMATION: Disclosure of this information is required by 30 U.S.C. 28f and 43 CFR Part 3830 for those qualified claimants wishing to take the small miner waiver allowed. Failure to supply the information required in this form to support the claimants certification of waiver from payment of the otherwise required maintenance fees will result in the waiver being disallowed and the mining claims subject to forfeiture by BLM under 30 U.S.C. 28i.

The Paperwork Reduction Act of 1995 requires us to inform you that: This information is being collected to allow the BLM to determine if you qualify for a waiver from the payment of \$100 per mining claim or site maintenance fee established in 30 U.S.C. 28f and the implementing regulations at 43 CFR 3830. A response to this request is required in accordance with the statute to obtain your benefit.

BLM would like you to know that you do not have to respond to this, or any other, Federal agency-sponsored information collection unless it displays a currently valid OMB control number.

Public reporting burden for this form is estimated to average 20 minutes (.33 hours) per response, including time to review instructions, gathering and maintaining data, and completing and reviewing the form. Direct comments regarding this burden estimate, or any other aspect of this form, to the U.S. Department of the Interior, Bureau of Land Management, (1004-0114) Bureau Information Collection Clearance Officer (WO-630), Mail Stop 401 LS, 1849 C St, N.W., Washington, D.C. 20240.

FOR OFFICIAL USE ONLY

PHOENIX, ARIZONA

2008 JUL 28 P 1:51

BLM, AZ STATE OFFICE

RECEIVED

AMC 368387

UNITED STATES
DEPARTMENT OF THE INTERIOR
BUREAU OF LAND MANAGEMENT

CREDIT CARD PAYMENT
FOR MINING CLAIM MAINTENANCE FEE

NAME Graham C. WILLIAMS

ADDRESS 3325 Mt. McKinley DR

CITY San Jose STATE CA ZIP 95127

PHONE # (408) 272-8139

SEND RECEIPT TO ABOVE ADDRESS
SEND RECEIPT TO: _____

AMC NUMBER

368388

CLAIM/SITE NAME

Thunder Canyon #23

ENTERED INTO COMPUTER

JUL 08 2008 RB

DATE STAMP

PHOENIX, ARIZONA
2008 JUL -7 P 2:41
RECEIVED
B.L.M. AZ STATE OFFICE

TELEPHONE SUBMISSION - ACCURACY OF THE ABOVE INFORMATION
IS THE RESPONSIBILITY OF THE CLAIMANT/OWNER

FOR OFFICIAL USE ONLY

DATE _____ INITIALS _____ VERIFIED _____

COUNT 1 \$ 125.00 INITIALS RB

United States Department of the Interior
Bureau of Land Management
 BUSINESS & SUPPORT SVCS DIV
 ONE N CENTRAL AVE SUITE 800
 PHOENIX, AZ 85004 -4427
 Phone: (602) 417-9200

Receipt

No: 1737170

Transaction #: 1794130	
Date of Transaction: 07/07/2008	
CUSTOMER:	GRAHAM C WILLIAMS 3325 MOUNT MCKINLEY DR SAN JOSE,CA 95127

LINE #	QTY	DESCRIPTION	REMARKS	UNIT PRICE	TOTAL
1	1.00	LOCATABLE MINERALS / MINING CLAIMS- NOT NEW-UNADJUD,ONE AUTH NO. ONLY / MINING CLAIM MONEY RECEIVED (455) CASES: AMC368388/\$125.00	MAINT 2009	- n/a -	125.00
TOTAL:					\$125.00

PAYMENT INFORMATION			
NOTE: Items will appear on credit card statement as "Bureau of Land Mgmt CO".			
1	AMOUNT:	\$125.00	POSTMARKED: N/A
	TYPE:	CREDIT CARD	RECEIVED: 07/07/2008
	NAME:	WILLIAMS, GRAHAM C 3325 MOUNT MCKINLEY DR SAN JOSE CA 95127	
	CARD NO:	XXXXXXXXXXXX6439	AUTH CODE: 007912
	NAME ON CARD:	GRAHAM C WILLIAMS	
	EXPIRES:	07/31/2008	
	SIGNATURE:		

REMARKS

This receipt was generated by the automated BLM Collections and Billing System and is a paper representation of a portion of the official electronic record contained therein.

When Recorded Return Document No:

GEORGE BERNIER
5662 VINEVALE CIRCLE
LAPALMA, CA, 90623

Check here if this is a change of address.

Telephone: 714-995-3815

E-mail address: DRGWB1@ADL.COM

AMC 381023

AMC 368387

AMC 367671

~~AMC 367671~~

~~AMC 367671~~

AFFIDAVIT OF PERFORMANCE OF ANNUAL WORK

RECEIVED
B.L.M. AZ STATE OFFICE
2007 NOV 19 A 8:18
PHOENIX, ARIZONA
BLM
Date
Stamp

1. State of Arizona, County of MARICOPA ss:

2. I (Name) GEORGE BERNIER

3. Reside at (Address) 5662 VINEVALE CIRCLE

City LA PALMA County ORANGE

State CA Zip 90623 being duly sworn, depose and say that I am a citizen of the United States, more than eighteen years of age, and that all of the facts set forth in this affidavit, subject to the provisions and penalties of 18 U.S.C. 1001 pertaining to the filing of false, fictitious, or fraudulent statements with the United States, are true and correct according to the best of my knowledge, information and belief.

4. Owner's name and address (if not shown in Items 1-3 above).

5. That I am personally acquainted with the mining claim(s). The work and improvements were made by and at the expense of the owner(s) of said claim(s). Said contiguous group of claims, listed on this document, are situated in the

SAN DOMINGO (optional) Mining District; MARICOPA County, Arizona.

Line No.	AMC NUMBER	CLAIM/SITE NAME	COUNTY RECORDER DATA (if available)	TWP	RNG	SEC
1	367671	RAINBOW'S END #5	05-1552881	7N	3W	7
2						
3						
4						
5						
6						

Form: MCF108

Revised Jan. 2006

Page 1 of 2

ENTERED IN COMPUTER

RE 12/5/07

RECEIVED
BLM - AZ STATE OFFICE
2007 NOV 19 A 8:18
PHOENIX, ARIZONA

BLM
Date
Stamp

7						
8						
9						
10						

6. That between the dates starting at 12 o'clock noon on September 1, 20 06 and ending at 12 o'clock noon on September 1, 20 07 at least \$ 100.00 dollars worth of work and improvements were done and performed upon said claim(s) or upon one or more of a contiguous group of claims for the benefit of all, wholly or partly outside of a contiguous group of claims for the benefit of all, not including the location work.

7. That the following persons were employed to perform the work and improvements described herein: _____
MYSELF

8. That the work and improvements performed were: MINING, ROAD IMPROVEMENTS, EXPLORATION, RECLAMATION

9. Dated: 11-14-07 Signature: [Signature]

SUBSCRIBED AND SWORN TO before me, a Notary Public, this 14TH day of NOV. 20 07

By: GEORGE WILLIAM BERNIER

Notary Public [Signature]

My Commission Expires 09-09-09



Bureau of Land Management
Arizona State Office
www.az.blm.gov

No. of Claims: 1 x \$10 = 10.00
 Check No.: 8428 Init. [Signature]
 Receipt No.: 1603630
 For BLM Use Only

When Recorded Return Document:

GEORGE BERNIER
5662 VINSVALE CIRCLE
LA PALMA, CA, 90623

Check here if this is a change of address.

Telephone: 714-995-3815

E-mail address: DRGWB1@AOL.COM

AFFIDAVIT OF PERFORMANCE OF ANNUAL WORK

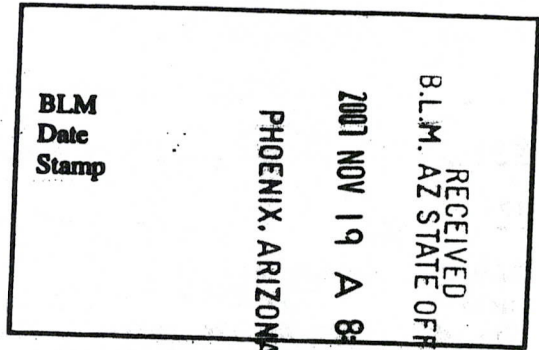

1. State of Arizona, County of MARICOPA/YAVAPAI ss:

2. I (Name) GEORGE BERNIER

3. Reside at (Address) 5662 VINSVALE CIRCLE

City LA PALMA County ORANGE

State CA Zip 90623 being duly sworn, depose and say that I am a citizen of the United States, more than eighteen years of age, and that all of the facts set forth in this affidavit, subject to the provisions and penalties of 18 U.S.C. 1001 pertaining to the filing of false, fictitious, or fraudulent statements with the United States, are true and correct according to the best of my knowledge, information and belief.

4. Owner's name and address (if not shown in Items 1-3 above).

5. That I am personally acquainted with the mining claim(s). The work and improvements were made by and at the expense of the owner(s) of said claim(s). Said contiguous group of claims, listed on this document, are situated in the

SAN DOMINGO (optional) Mining District; MARICOPA/YAVAPAI County, Arizona.

Line No.	AMC NUMBER	CLAIM/SITE NAME	COUNTY RECORDER DATA (if available)	TWP	RNG	SEC
1	368387	RAINBOWS END #8	05-1760761 (MARICOPA) 3966798 B-4355 P-805 (YAVAPAI)	7N	3W	8
2						
3						
4						
5						
6						

RECEIVED
 B.L.M. AZ STATE OFFICE
 BLM
 NOV 19 A 8:17
 Stamp
 PHOENIX, ARIZONA

7						
8						
9						
10						

6. That between the dates starting at 12 o'clock noon on September 1, 20 06 and ending at 12 o'clock noon on September 1, 20 07 at least \$ 100.00 dollars worth of work and improvements were done and performed upon said claim(s) or upon one or more of a contiguous group of claims for the benefit of all, wholly or partly outside of a contiguous group of claims for the benefit of all, not including the location work.

7. That the following persons were employed to perform the work and improvements described herein: _____
MYSELF

8. That the work and improvements performed were: MINING, ROAD IMPROVEMENTS, EXPLORATION, RECLAMATION

9. Dated: 11-14-07 Signature: [Signature]

SUBSCRIBED AND SWORN TO before me, a Notary Public, this 14TH day of Nov. 2007

By: GEORGE WILLIAM BERNIER

Notary Public [Signature]

My Commission Expires 09-09-09



No. of Claims: 1 x \$10 = 10.
 Check No.: 2429 Init. [Signature]
 Receipt No.: 1603630
 For BLM Use Only

Bureau of Land Management
 Arizona State Office
www.az.blm.gov

Form: MCF108
 Revised Jan. 2006
 Page 2 of 2

When Recorded Return Document is to:
GEORGE BERNIER
5662 VINEVALE CIRCLE
LAPALMA, CA. 90623

Check here if this is a change of address.
 Telephone: 714-995-3815
 E-mail address: DRGWB1@ADL.COM

AFFIDAVIT OF PERFORMANCE OF ANNUAL WORK

1. State of Arizona, County of MARICOPA ss:
 2. I (Name) GEORGE BERNIER
 3. Reside at (Address) 5662 VINEVALE CIRCLE
 City LA PALMA County ORANGE

RECEIVED
 B.L.M. AZ STATE OFFICE
 2007 NOV 19 A 8:19
 PHOENIX, ARIZONA
 BLM
 Date
 Stamp

State CA Zip 90623 being duly sworn, depose and say that I am a citizen of the United States, more than eighteen years of age, and that all of the facts set forth in this affidavit, subject to the provisions and penalties of 18 U.S.C. 1001 pertaining to the filing of false, fictitious, or fraudulent statements with the United States, are true and correct according to the best of my knowledge, information and belief.

4. Owner's name and address (if not shown in items 1-3 above).

5. That I am personally acquainted with the mining claim(s). The work and improvements were made by and at the expense of the owner(s) of said claim(s). Said contiguous group of claims, listed on this document, are situated in the

SAN DOMINGO (optional) Mining District; MARICOPA County, Arizona.

Line No.	AMC NUMBER	CLAIM/SITE NAME	COUNTY RECORDER DATA (if available)	TWP	RNG	SEC
1	381024	THUNDERCANYON	07-0484401	7N	4W	25
2						
3						
4						
5						
6						

BLM
Date
Stamp

2007 NOV 19 A 8:19

PHOENIX, ARIZONA

RECEIVED
B.L.M. AZ STATE OFFICE

7					
8					
9					
10					

6. That between the dates starting at 12 o'clock noon on September 1, 20 06 and ending at 12 o'clock noon on September 1, 20 07 at least \$ 100.00 dollars worth of work and improvements were done and performed upon said claim(s) or upon one or more of a contiguous group of claims for the benefit of all, wholly or partly outside of a contiguous group of claims for the benefit of all, not including the location work.

7. That the following persons were employed to perform the work and improvements described herein: _____
MYSELF

8. That the work and improvements performed were: MINING, ROAD IMPROVEMENTS, EXPLORATION, RECLAMATION

9. Dated: 11-14-07 Signature: [Signature]

SUBSCRIBED AND SWORN TO before me, a Notary Public, this 14th day of NOVEMBER 2007

By: GEORGE WILLIAM BERNIER
Notary Public [Signature]
My Commission Expires 09-09-09



Bureau of Land Management
Arizona State Office
www.az.blm.gov

No. of Claims: 1 x \$10 = 10.⁰⁰
Check No.: 8430 Init. TB
Receipt No.: 1603630
For BLM Use Only

Form: MCF108
Revised Jan. 2006
Page 2 of 2

United States Department of the Interior
Bureau of Land Management
 BUSINESS & SUPPORT SVCS DIV
 ONE N CENTRAL AVE SUITE 800
 PHOENIX, AZ 85004 -4427
 Phone: (602) 417-9200

Receipt

No:

1603630

Transaction #: 1656173	
Date of Transaction: 11/19/2007	
CUSTOMER:	GEORGE BERNIER 5662 VINEVALE CIRCLE LA PALMA, CA 90623

LINE #	QTY	DESCRIPTION	REMARKS	UNIT PRICE	TOTAL
1	1.00	LOCATABLE MINERALS / MINING CLAIMS-NOT NEW-UNADJUD, ONE AUTH NO. ONLY / MINING CLAIM MONEY RECEIVED (455) CASES: AMC368387/\$30.00	POL 2007 (3)	- n/a -	30.00
TOTAL:					\$30.00

PAYMENT INFORMATION					
1	AMOUNT:	\$10.00	POSTMARKED:	11/15/07 0:00	
	TYPE:	CHECK	RECEIVED:	11/19/2007	
	CHECK NO:	2428			
	NAME:	BERNIER, GEORGE W 5662 VINEVALE CIRCLE LA PALMA CA 90623			
2	AMOUNT:	\$10.00	POSTMARKED:	11/15/07 0:00	
	TYPE:	CHECK	RECEIVED:	11/19/2007	
	CHECK NO:	2429			
	NAME:	BERNIER, GEORGE W 5662 VINEVALE CIRCLE LA PALMA CA 90623			
3	AMOUNT:	\$10.00	POSTMARKED:	11/15/07 0:00	
	TYPE:	CHECK	RECEIVED:	11/19/2007	
	CHECK NO:	2430			
	NAME:	BERNIER, GEORGE W 5662 VINEVALE CIRCLE LA PALMA CA 90623			

REMARKS

This receipt was generated by the automated BLM Collections and Billing System and is a paper representation of a portion of the official electronic record contained therein.

UNITED STATES DEPARTMENT OF THE INTERIOR
BUREAU OF LAND MANAGEMENT

243

AMC 368387

FORM APPROVED
OMB NO. 1004-0114
Expires: February 28, 2010

MAINTENANCE FEE WAIVER CERTIFICATION

SEE INSTRUCTIONS ON REVERSE

AMC 367671

AMC 381023

1. This small miner waiver is filed for the assessment year beginning at noon on September 1, ~~2006~~ and ending at noon on September 1, ~~2007~~ 2008
2. The undersigned and all related parties owned ten or fewer mining claims, mill, or tunnel sites located and maintained on Federal lands in the United States of America on September 1, ~~2007~~ 2008
3. The undersigned have performed the assessment work **required by law** for each mining claim listed **prior to filing this waiver** and understand that by filing this form; an affidavit of assessment work **must** be recorded by the December 30th following the filing of this waiver.
4. The undersigned understand that if the assessment work obligation has not yet come due under 30 U.S.C. 28 (for those claims in their first assessment year only); a notice of intent to hold reciting this condition **must** be recorded by the December 30th following the filing of this waiver.
5. The undersigned understand that mill and tunnel sites may also be listed upon this waiver and be waived from payment of the maintenance fee; and that a notice of intent to hold for these sites is required to be recorded by the December 30th immediately following the filing of this waiver.
6. The undersigned understand and acknowledge that pursuant to 43 U.S.C. 1212 and 18 U.S.C. 1001; the filing or recording of a false, fictitious, or fraudulent document with the Bureau of Land Management may result in a fine of up to \$250,000, a prison term not to exceed five years, or both.
7. The mining claims, mill or tunnel sites for which this waiver from payment of the maintenance fees is requested are:

CLAIM OR SITE NAME	BLM RECORDATION SERIAL NUMBER
1. RAINBOW'S END #5	AMC 367671
2. RAINBOW'S END #8	AMC 368387
3. THUNDER CANYON	AMC 381024
4.	
5.	
6.	
7.	
8.	
9.	
10.	

The owner(s) (claimants) of the above mining claims and sites are:

GEORGE BERNIER
(Owner's Name - Please Print)
5662 VINEVALE CIRCLE
(Street or P.O. Box)
LA PALMA CA 90623
(City) (State) (Zip Code)

George W. Bernier
(Owner's Signature)

JOAN BERNIER
(Owner's Name - Please Print)
5662 VINEVALE CIRCLE
(Street or P.O. Box)
LA PALMA CA 90623
(City) (State) (Zip Code)

Joan M. Bernier
(Owner's Signature)

(Owner's Name - Please Print)

(Street or P.O. Box)

(City) (State) (Zip Code)

(Owner's Signature)

(Continued on page 2)

ENTERED IN COMPUTER

8/20/07 RZ

(Owner's Name - Please Print)	(Owner's Signature)		
(Street or P.O. Box)	(City)	(State)	(Zip Code)
(Owner's Name - Please Print)	(Owner's Signature)		
(Street or P.O. Box)	(City)	(State)	(Zip Code)
(Owner's Name - Please Print)	(Owner's Signature)		
(Street or P.O. Box)	(City)	(State)	(Zip Code)
(Owner's Name - Please Print)	(Owner's Signature)		
(Street or P.O. Box)	(City)	(State)	(Zip Code)

INSTRUCTIONS

- | | |
|--|---|
| <ol style="list-style-type: none"> 1. This certification is made under the provisions of § 1744 of Title 43 and § 28-28k of Title 30 of the United States Code; and the regulations thereunder (43 CFR Part 3830). 2. The claimant(s) must fill in the dates in paragraph 1 for the beginning and ending of the assessment year for which this waiver is sought. 3. The claimant(s) must fill in the date in paragraph 2 for the beginning of the assessment year for which this waiver is sought. 4. All claim and site names and Bureau of Land Management (BLM) serial numbers must be listed for the mining claims, mill sites, and tunnel sites for which the waiver is sought. 5. All owners of the mining claims, mill sites, and tunnel sites and their addresses must be given. 6. This waiver form must be signed by all the claimants or their designated agent, in original form. If an agent is designated, a notarized designation of agent, signed by all of the claimants with proper address given, must be submitted with this waiver. | <ol style="list-style-type: none"> 7. This form must be filed no later than September 1st for the upcoming assessment year in the BLM State Office where the mining claims or sites are recorded, or the waiver cannot be granted by the BLM. (Example: to obtain a waiver for the assessment year 2000, which begins at noon on September 1, 1999, you must qualify for and file for a waiver no later than September 1, 1999, in the proper BLM State Office). 8. For all mining claims which require assessment work, you must record an affidavit of labor on or before the December 30th immediately following the filing of this waiver. For all other mining claims or sites waived, you must record a notice of intent to hold on or before the December 30th immediately following the filing of this waiver. 9. Mill and tunnel sites may also be listed upon this waiver and be waived from payment of the maintenance fee. A notice of intent to hold for these sites is required to be filed by the December 30th following the filing of this waiver. |
|--|---|

NOTICE/BURDEN HOURS STATEMENT

The Privacy Act of 1974, *as amended*, and the regulation in 43 CFR 2.48(d) provide that you be furnished the following information in connection with the information required by this certification of waiver from rental fees.

AUTHORITY: 30 U.S.C. 28-28k; 43 U.S.C. 1201, 1457, 1740, and 1744; and 43 CFR 3830.

PRINCIPLE PURPOSE: This information is to be used to verify that the owner(s) (claimants) of a mining claim has complied with 30 U.S.C. 28f and is entitled to perform assessment work in lieu of paying the maintenance fee for the mining claims listed on this form.

ROUTINE USE: (1) Adjudication of the claimant(s) certification of waiver from paying the maintenance fee otherwise required by 30 U.S.C. 28f. (2) Disclosure may be made to appropriate Federal agencies when location is made within the agency's geographic area of responsibility. (3) Information from the record and/or the record will be transferred to the appropriate Federal, State, or local agency, or a member of the public in response to a specific request for pertinent information. (4) Information may also be provided to the Department of Justice or in a proceeding before a court or adjudicative body; or to Federal, State, local or foreign agencies when needed for enforcement of civil or criminal codes or applicable regulations concerning title rights upon the public land.

EFFECT OF NOT PROVIDING INFORMATION: Disclosure of this information is required by 30 U.S.C. 28f and 43 CFR Part 3830 for those qualified claimants wishing to take the small miner waiver allowed. Failure to supply the information required in this form to support the claimants certification of waiver from payment of the otherwise required maintenance fees will result in the waiver being disallowed and the mining claims subject to forfeiture by BLM under 30 U.S.C. 28i.

The Paperwork Reduction Act of 1995 requires us to inform you that:

This information is being collected to allow the BLM to determine if you qualify for a waiver from the payment of \$100 per mining claim or site maintenance fee established in 30 U.S.C. 28f and the implementing regulations at 43 CFR 3830. A response to this request is required in accordance with the statute to obtain your benefit.

BLM would like you to know that you do not have to respond to this, or any other, Federal agency-sponsored information collection unless it displays a currently valid OMB control number.

Public reporting burden for this form is estimated to average 20 minutes (.33 hours) per response, including time to review instructions, gathering and maintaining data, and completing and reviewing the form. Direct comments regarding this burden estimate, or any other aspect of this form, to the U.S. Department of the Interior, Bureau of Land Management, (1004-0114) Bureau Information Collection Clearance Officer (WO-630), Mail Stop 401 LS, 1849 C St., N.W., Washington, D.C. 20240.

FOR OFFICIAL USE ONLY

RECEIVED
BLM, AZ STATE OFFICE
AUG 16 8:13
PHOENIX, ARIZONA

AMC 368387

United States Department of the Interior

BUREAU OF LAND MANAGEMENT
ARIZONA STATE OFFICE
ONE NORTH CENTRAL
SUITE # 800
PHOENIX, AZ 85004

MINING CLAIM MAINTENANCE FEE 2008

NAME: *Graham C. Williams*

ADDRESS: *3325 Mount McKinley Dr.*

CITY: *San Jose* STATE ZIP PHONE *480*

95127
272
8139

SEND RECEIPT TO ABOVE ADDRESS

SEND RECEIPT TO :

AMC NUMBER	CLAIM/SITE NAME
<i>368388</i>	<i>Canyon Thunder Canyon #23</i>

TELEPHONE SUBMISSION - ACCURACY OF THE ABOVE INFORMATION IS THE RESPONSIBILITY OF THE CLAIMANT/OWNER

FOR OFFICIAL USE ONLY

DATE INITIALS SC VERIFIED

COUNT \$ INITIALS

PHOENIX, ARIZONA
2007 AUG - 8 - 10:49
RECEIVED B.L.M. AZ STATE OFFICE

DATE STAMP

United States Department of the Interior
Bureau of Land Management
 BUSINESS & SUPPORT SVCS DIV
 ONE N CENTRAL AVE SUITE 800
 PHOENIX, AZ 85004 -4427
 Phone: (602) 417-9200

Receipt

No: 1544506

Transaction #: 1595886	
Date of Transaction: 08/15/2007	
CUSTOMER:	GRAHAM C WILLIAMS 3325 MOUNT MCKINLEY DR SAN JOSE, CA 95127

LINE #	QTY	DESCRIPTION	REMARKS	UNIT PRICE	TOTAL
1	1.00	LOCATABLE MINERALS / MINING CLAIMS-NOT NEW-UNADJUD, ONE AUTH NO. ONLY / MINING CLAIM MONEY RECEIVED (455) CASES: AMC368388/\$125.00	MAINT 2008 (1)	- n/a -	125.00
TOTAL:					\$125.00

PAYMENT INFORMATION			
NOTE: Items will appear on credit card statement as "Bureau of Land Management".			
1	AMOUNT:	\$125.00	POSTMARKED: N/A
	TYPE:	CREDIT CARD	RECEIVED: 08/15/2007
	NAME:	WILLIAMS, GRAHAM C 3325 MOUNT MCKINLEY DR SAN JOSE CA 95127	
	CARD NO:	XXXXXXXXXXXX6439	AUTH CODE: 015072
	NAME ON CARD:	GRAHAM C WILLIAMS	
	EXPIRES:	07/31/2008	
	SIGNATURE:		

REMARKS

This receipt was generated by the automated BLM Collections and Billing System and is a paper representation of a portion of the official electronic record contained therein.

When Recorded Return Document to:

GEORGE BERNIER
5662 VINEYALE CIRCLE
LA PALMA, CA. 90623

Check here if this is a change of address.

Telephone: 714-995-3815

E-mail address: DRGWB1@ADL.COM

AMC 368387

AFFIDAVIT OF PERFORMANCE OF ANNUAL WORK

1. State of Arizona, County of MARICOPA/YAVAPAI ss:

2. I (Name) GEORGE BERNIER

3. Reside at (Address) 5662 VINEYALE CIRCLE

City LA PALMA County ORANGE

State CA Zip 90623 being duly sworn, depose and say that I am a citizen of the United States, more than eighteen years of age, and that all of the facts set forth in this affidavit, subject to the provisions and penalties of 18 U.S.C. 1001 pertaining to the filing of false, fictitious, or fraudulent statements with the United States, are true and correct according to the best of my knowledge, information and belief.

4. Owner's name and address (If not shown in Items 1-3 above).

5. That I am personally acquainted with the mining claim(s). The work and improvements were made by and at the expense of the owner(s) of said claim(s). Said contiguous group of claims, listed on this document, are situated in the

SAN DOMINGO (optional) Mining District; MARICOPA/YAVAPAI County, Arizona.

RECEIVED
BLM, AZ STATE OFFICE
PHOENIX, ARIZONA
2006 DEC -5 A 10:15
BLM
Date
Stamp

Line No.	AMC NUMBER	CLAIM/SITE NAME	COUNTY RECORDER DATA (If available)	TWP	RNG	SEC
1	368387	RAINBOWS END #8	05-1760761 (MARICOPA) 3966798 B-4355 P-885 (YAVAPAI)	7N	3W	8
2						
3						
4						
5						
6						

RE 1/17/07

RECEIVED
B.L.M. AZ STATE OFFICE

2006 DEC -5 A 10:15
BLM
Date
Stamp
PHOENIX, ARIZONA

7						
8						
9						
10						

6. That between the dates starting at 12 o'clock noon on September 1, 20 05 and ending at 12 o'clock noon on September 1, 20 06 at least \$ 100.00 dollars worth of work and improvements were done and performed upon said claim(s) or upon one or more of a contiguous group of claims for the benefit of all, wholly or partly outside of a contiguous group of claims for the benefit of all, not including the location work.

7. That the following persons were employed to perform the work and improvements described herein: _____
MYSELF

8. That the work and improvements performed were: MINING, ROAD IMPROVEMENTS,
EXPLORATION, RECLAMATION

9. Dated: 11-28-06 Signature: George W. Bernier

SUBSCRIBED AND SWORN TO before me, a Notary Public, this 28TH day of NOV. 2006

By: GEORGE WILLIAM BERNIER

Notary Public JK

My Commission Expires SEPT. 09. 2009

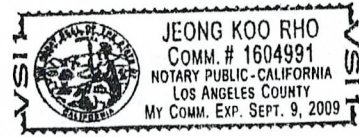

Bureau of Land Management
Arizona State Office
www.az.blm.gov

No. of Claims: _____ x \$10 = _____
Check No.: _____ Init. _____
Receipt No.: _____
For BLM Use Only

United States Department of the Interior
Bureau of Land Management
 BUSINESS & SUPPORT SVCS DIV
 ONE N CENTRAL AVE SUITE 800
 PHOENIX, AZ 85004 -4427
 Phone: (602) 417-9200

Receipt

No:

1402766

Transaction #: 1449231	
Date of Transaction: 12/06/2006	
CUSTOMER:	GEORGE BERNIER 5662 VINEVALE CIRCLE LA PALMA,CA 90623

LINE #	QTY	DESCRIPTION	REMARKS	UNIT PRICE	TOTAL
1	1.00	LOCATABLE MINERALS / MINING CLAIMS-NOT NEW-UNADJUD,ONE AUTH NO. ONLY / MINING CLAIM MONEY RECEIVED (455) CASES: AMC368387/\$10.00	POL (1)	- n/a -	10.00
TOTAL:					\$10.00

PAYMENT INFORMATION					
1	AMOUNT:	\$10.00	POSTMARKED:	11/29/2006	
	TYPE:	CHECK	RECEIVED:	12/05/2006	
	CHECK NO:	1963			
	NAME:	BERNIER, GEORGE W 5662 VINEVALE CIRCLE LA PALMA CA 90623			

REMARKS

This receipt was generated by the automated BLM Collections and Billing System and is a paper representation of a portion of the official electronic record contained therein.

UNITED STATES DEPARTMENT OF THE INTERIOR
BUREAU OF LAND MANAGEMENT

104 RE

AMC 367671
FORM APPROVED
OMB NO. 1004-0114
Expires: December 31, 2006

MAINTENANCE FEE WAIVER CERTIFICATION

SEE INSTRUCTIONS ON REVERSE

AMC 368387

1. This small miner waiver is filed for the assessment year beginning at noon on September 1, ~~2005~~ and ending at noon on September 1, ~~2006~~.
2. The undersigned and all related parties owned ten or fewer mining claims, mill, or tunnel sites located and maintained on Federal lands in the United States of America on September 1, ~~2006~~.
3. The undersigned have performed the assessment work **required by law** for each mining claim listed **prior to filing this waiver** and understand that by filing this form; an affidavit of assessment work **must** be recorded by the December 30th following the filing of this waiver.
4. The undersigned understand that if the assessment work obligation has not yet come due under 30 U.S.C. 28 (for those claims in their first assessment year only); a notice of intent to hold reciting this condition **must** be recorded by the December 30th following the filing of this waiver.
5. The undersigned understand that mill and tunnel sites may also be listed upon this waiver and be waived from payment of the maintenance fee; and that a notice of intent to hold for these sites is required to be recorded by the December 30th immediately following the filing of this waiver.
6. The undersigned understand and acknowledge that pursuant to 43 U.S.C. 1212 and 18 U.S.C. 1001; the filing or recording of a false, fictitious, or fraudulent document with the Bureau of Land Management may result in a fine of up to \$250,000, a prison term not to exceed five years, or both.
7. The mining claims, mill or tunnel sites for which this waiver from payment of the maintenance fees is requested are:

CLAIM OR SITE NAME	BLM RECORDATION SERIAL NUMBER
1. RAINBOW'S END #5	AMC 367671
2. RAINBOW'S END #8	AMC 368387
3.	
4.	
5.	
6.	
7.	
8.	
9.	
10.	

The owner(s) (claimants) of the above mining claims and sites are:

GEORGE BERNIER
(Owner's Name - Please Print)
5662 VINEVALE CIRCLE
(Street or P.O. Box)
LA PALMA CA 90623
(City) (State) (Zip Code)

George Bernier
(Owner's Signature)

JOAN BERNIER
(Owner's Name - Please Print)
5662 VINEVALE CIRCLE
(Street or P.O. Box)
LA PALMA CA 90623
(City) (State) (Zip Code)

Jean M. Bernier
(Owner's Signature)

(Owner's Name - Please Print)

(Owner's Signature)

(Street or P.O. Box)

(City)

(State)

(Zip Code)

(Continued on page 2)

ENTERED IN COMPUTER

RE 7/31/06

(Owner's Name - Please Print)

(Street or P.O. Box)

(Owner's Name - Please Print)

(Street or P.O. Box)

(Owner's Name - Please Print)

(Street or P.O. Box)

(Owner's Name - Please Print)

(Street or P.O. Box)

(Owner's Signature)

(City) (State) (Zip Code)

(Owner's Signature)

(City) (State) (Zip Code)

(Owner's Signature)

(City) (State) (Zip Code)

(Owner's Signature)

(City) (State) (Zip Code)

INSTRUCTIONS

- 1. This certification is made under the provisions of § 1744 of Title 43 and § 28-28k of Title 30 of the United States Code; and the regulations thereunder (43 CFR Part 3830).
- 2. The claimant(s) must fill in the dates in paragraph 1 for the beginning and ending of the assessment year for which this waiver is sought.
- 3. The claimant(s) must fill in the date in paragraph 2 for the beginning of the assessment year for which this waiver is sought.
- 4. All claim and site names and Bureau of Land Management (BLM) serial numbers must be listed for the mining claims, mill sites, and tunnel sites for which the waiver is sought.
- 5. All owners of the mining claims, mill sites, and tunnel sites and their addresses must be given.
- 6. This waiver form must be signed by all the claimants or their designated agent, in original form. If an agent is designated, a notarized designation of agent, signed by all of the claimants with proper address given, must be submitted with this waiver.

- 7. This form must be filed no later than September 1st for the upcoming assessment year in the BLM State Office where the mining claims or sites are recorded, or the waiver cannot be granted by the BLM. (Example: to obtain a waiver for the assessment year 2000, which begins at noon on September 1, 1999, you must qualify for and file for a waiver no later than September 1, 1999, in the proper BLM State Office).
- 8. For all mining claims which require assessment work, you must record an affidavit of labor on or before the December 30th immediately following the filing of this waiver. For all other mining claims or sites waived, you must record a notice of intent to hold on or before the December 30th immediately following the filing of this waiver.
- 9. Mill and tunnel sites may also be listed upon this waiver and be waived from payment of the maintenance fee. A notice of intent to hold for these sites is required to be filed by the December 30th following the filing of this waiver.

NOTICE/BURDEN HOURS STATEMENT

The Privacy Act of 1974, as amended, and the regulation in 43 CFR 2.48(d) provide that you be furnished the following information in connection with the information required by this certification of waiver from rental fees.

AUTHORITY: 30 U.S.C. 28-28k; 43 U.S.C. 1201, 1457, 1740, and 1744; and 43 CFR 3830.

PRINCIPLE PURPOSE: This information is to be used to verify that the owner(s) (claimants) of a mining claim has complied with 30 U.S.C. 28f and is entitled to perform assessment work in lieu of paying the maintenance fee for the mining claims listed on this form.

ROUTINE USE: (1) Adjudication of the claimant(s) certification of waiver from paying the maintenance fee otherwise required by 30 U.S.C. 28f. (2) Disclosure may be made to appropriate Federal agencies when location is made within the agency's geographic area of responsibility. (3) Information from the record and/or the record will be transferred to the appropriate Federal, State, or local agency, or a member of the public in response to a specific request for pertinent information. (4) Information may also be provided to the Department of Justice or in a proceeding before a court or adjudicative body, or to Federal, State, local or foreign agencies when needed for enforcement of civil or criminal codes or applicable regulations concerning title rights upon the public land.

EFFECT OF NOT PROVIDING INFORMATION: Disclosure of this information is required by 30 U.S.C. 28f and 43 CFR Part 3830 for those qualified claimants wishing to take the small miner waiver allowed. Failure to supply the information required in this form to support the claimants certification of waiver from payment of the otherwise required maintenance fees will result in the waiver being disallowed and the mining claims subject to forfeiture by BLM under 30 U.S.C. 28i.

The Paperwork Reduction Act of 1995 requires us to inform you that: This information is being collected to allow the BLM to determine if you qualify for a waiver from the payment of \$100 per mining claim or site maintenance fee established in 30 U.S.C. 28f and the implementing regulations at 43 CFR 3830. A response to this request is required in accordance with the statute to obtain your benefit.

BLM would like you to know that you do not have to respond to this, or any other, Federal agency-sponsored information collection unless it displays a currently valid OMB control number.

Public reporting burden for this form is estimated to average 8 minutes (0.133 hours) per response, including time to review instructions, gathering and maintaining data, and completing and reviewing the form. Direct comments regarding this burden estimate, or any other aspect of this form, to the U.S. Department of the Interior, Bureau of Land Management, (1004-0114) Bureau Information Collection Clearance Officer (WO-630), Mail Stop 401, L.S., 1849 C St., N.W., Washington, D.C. 20240.

FOR OFFICIAL USE ONLY

ARIZONA STATE OFFICE HOENIK, ARIZONA

JUL 28 P 2:04

RECEIVED BUREAU OF LAND MANAGEMENT

AMC 368387

UNITED STATES
DEPARTMENT OF THE INTERIOR
BUREAU OF LAND MANAGEMENT

CREDIT CARD PAYMENT
FOR MINING CLAIM MAINTENANCE FEE

NAME Graham C. Williams

ADDRESS 3325 Mount McKinley DR

CITY San Jose STATE CA ZIP 95127

PHONE # (408) 272-8139

[] THIS IS A CHANGE OF ADDRESS

AMC NUMBER

CLAIM/SITE NAME

368388

Thunder Canyon #23

DATE STAMP

COUNT 1 \$ 125⁰⁰ INITIALS TR

RECEIVED
B.L.M. AZ STATE OFFICE
2006 JUL 25 P 12:22
PHOENIX, ARIZONA

TELEPHONE SUBMISSION - ACCURACY OF THE ABOVE INFORMATION
IS THE RESPONSIBILITY OF THE CLAIMANT/OWNER

FOR OFFICIAL USE ONLY

JUL 26 2006
DATE

FB
INITIALS

FB
VERIFIED

United States Department of the Interior
Bureau of Land Management
 BUSINESS & SUPPORT SVCS DIV
 ONE N CENTRAL AVE
 PHOENIX, AZ 85004 -2203
 Phone: (602) 417-9200

Receipt

No: 1321326

Transaction #: 1366124		ENTERED IN COMPUTER JUL 26 2006 (B)
Date of Transaction: 07/25/2006		
CUSTOMER:	GRAHAM C WILLIAMS 3325 MOUNT MCKINLEY DR SAN JOSE, CA 95127	

LINE #	QTY	DESCRIPTION	REMARKS	UNIT PRICE	TOTAL
1	1.00	LOCATABLE MINERALS / MINING CLAIMS-NOT NEW-UNADJUD, ONE AUTH NO. ONLY / MINING CLAIM MONEY RECEIVED (455) CASES: AMC368388/\$125.00	MAINT 2007 (1)	- n/a -	125.00
TOTAL:					\$125.00

PAYMENT INFORMATION			
NOTE: Items will appear on credit card statement as "Bureau of Land Management".			
1	AMOUNT:	\$125.00	POSTMARKED: N/A
	TYPE:	CREDIT CARD	RECEIVED: 07/25/2006
	NAME:	WILLIAMS, GRAHAM C 3325 MOUNT MCKINLEY DR SAN JOSE CA 95127	
	CARD NO:	XXXXXXXXXXXX6439	AUTH CODE: 025089
	NAME ON CARD:	GRAHMAN C WILLIAMS	
	EXPIRES:	07/31/2006	
	SIGNATURE:		

REMARKS	

This receipt was generated by the automated BLM Collections and Billing System and is a paper representation of a portion of the official electronic record contained therein.

NOTICE!!

These documents have been scanned!

Do not place un-scanned documents beneath this notice!

Do not remove this notice from this file!

GPO Jacket No. 560-102
Print Order 61540
Rise Business Services, LLC
Job=AZ15 6/3/2019



Box Number= AZ15110



Claim Begin-End: AMC368387-AMC368388

5 Miscellaneous



AZ15110-7

AMC367879-AMC368659

368388
368387

BLM:

COA: AZMC368388 11/27/2018

Please update my (our) mailing (Home) -
Address as follows -

Address -

From:

Graham C. Williams, Cherie V.
3325 Mc. McKinley Dr.
San Jose, CA 95127

To:

Graham C. Williams, Cherie V.
4330 Majestic View St.
Pahrump, NV 89066-1515

Thank You

Graham C. Williams / John C. Williams
Cherie V. Williams / Cherie V. Williams

RECEIVED
BLM AZ STATE OFFICE
310 DEC 3 P 3:02
PHOENIX ARIZONA

GCW (408) 250-1482

CVW (408) 221-4578

Date and Time Run:
2/1/2019 10:41:24 AM

**DEPARTMENT OF THE INTERIOR
BUREAU OF LAND MANAGEMENT**

Mining Claims

CUSTOMER INFORMATION

Admin State: AZ

Geo State: AZ

**WILLIAMS GRAHAM C
3325 MOUNT MCKINLEY DR
SAN JOSE CA 95127-4808**

Int Rel: CLAIMANT

Customer ID: 2233226

Serial Number	Lead Serial Number	Claim Name	County	D	Case Type	Last A Yr	Location Date	Meridian Township Range Section	Subdiv
AMC368388	AMC368387	THUNDER CANYON #23	MARICOPA	A	PLACER	2019	11/10/2005	14 0070N 0040W 023	SW

**NO WARRANTY IS MADE BY BLM
FOR USE OF THE DATA FOR
PURPOSES NOT INTENDED BY BLM**

Date and Time Run:
2/1/2019 10:45:17 AM

**DEPARTMENT OF THE INTERIOR
BUREAU OF LAND MANAGEMENT**

Mining Claims

CUSTOMER INFORMATION

Admin State: AZ

Geo State: AZ

**WILLIAMS CHERIE V
3325 MOUNT MCKINLEY DR
SAN JOSE CA 95127-4808**

Int Rel: CLAIMANT

Customer ID: 2233227

Serial Number	Lead Serial Number	Claim Name	County	D	Case Type	Last A Yr	Location Date	Meridian Township Range Section	Subdiv
AMC368388	AMC368387	THUNDER CANYON #23	MARICOPA	A	PLACER	2019	11/10/2005	14 0070N 0040W 023	SW

**NO WARRANTY IS MADE BY BLM
FOR USE OF THE DATA FOR
PURPOSES NOT INTENDED BY BLM**

Graham Williams

4330 Majestic View St. LAS VEGAS NV 890

Pahrump, NV 89060 29 NOV 2018 PM 5 L



RECEIVED
BLM AZ STATE OFFICE
2018 DEC -3 P 3:12
PHOENIX, ARIZONA

BLM

Arizona State Office

One North Central Ave,
Suite 800

Phoenix, AZ 85004

ATTN: 442700

Change of Address

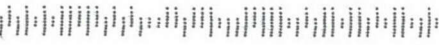

368388
368387

BLM:

COA: AZMC368388 11/27/2018

Please update my (our) mailing (Home) address as follows -

Address -

From:

Graham C. Williams, Cherie V.
3325 Mc. McKinley Dr.
San Jose, CA 95127

To:

Graham C. Williams, Cherie V.
4330 Majestic View St.
Pahrump, NV 89066-1515

Thank You

Graham C. Williams / *[Signature]*
Cherie V. Williams / *[Signature]*

RECEIVED
BLM AZ STATE OFFICE
2018 DEC 3 P 3:12
PHOENIX, ARIZONA

GCW (408) 250-1482
CVW (408) 221-4578

Date and Time Run:

2/1/2019 10:41:24 AM

Page 1 of @{numberOfPages}

**DEPARTMENT OF THE INTERIOR
BUREAU OF LAND MANAGEMENT****Mining Claims****CUSTOMER INFORMATION****Admin State: AZ****Geo State: AZ****WILLIAMS GRAHAM C
3325 MOUNT MCKINLEY DR
SAN JOSE CA 95127-4808****Int Rel: CLAIMANT****Customer ID: 2233226**

Serial Number	Lead Serial Number	Claim Name	County	D	Case Type	Last A Yr	Location Date	Meridian Township Range Section	Subdiv
AMC368388	AMC368387	THUNDER CANYON #23	MARICOPA	A	PLACER	2019	11/10/2005	14 0070N 0040W 023	SW

**NO WARRANTY IS MADE BY BLM
FOR USE OF THE DATA FOR
PURPOSES NOT INTENDED BY BLM**

Date and Time Run:

2/1/2019 10:45:17 AM

Page 1 of @{numberOfPages}

**DEPARTMENT OF THE INTERIOR
BUREAU OF LAND MANAGEMENT****Mining Claims****CUSTOMER INFORMATION****Admin State: AZ****Geo State: AZ****WILLIAMS CHERIE V
3325 MOUNT MCKINLEY DR
SAN JOSE CA 95127-4808****Int Rel: CLAIMANT****Customer ID: 2233227**

Serial Number	Lead Serial Number	Claim Name	County	D	Case Type	Last A Yr	Location Date	Meridian Township Range Section	Subdiv
AMC368388	AMC368387	THUNDER CANYON #23	MARICOPA	A	PLACER	2019	11/10/2005	14 0070N 0040W 023	SW

**NO WARRANTY IS MADE BY BLM
FOR USE OF THE DATA FOR
PURPOSES NOT INTENDED BY BLM**

Graham Williams
4330 Majestic View St
Pahrump, NV 89060

LAS VEGAS NV 890
29 NOV 2018 PM 5 L

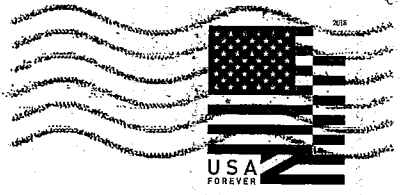

RECEIVED
BLM AZ STATE OFFICE
2018 DEC -3 P 3:12
PHOENIX, ARIZONA

BLM
Arizona State Office
One North Central Ave,
Suite 800
Phoenix, AZ 85004

ATTN: Change of Address

NOTICE!!

These documents have been scanned!

Do not place un-scanned documents beneath this notice!

Do not remove this notice from this file!

GPO Jacket No. 560-102
Print Order 61540
Rise Business Services, LLC
Job=AZ15 6/3/2019



Box Number= AZ15110



Claim Begin-End: AMC368387-AMC368388

6 Location Notices-Amendments and Supporting Documents



AZ15110-7

AMC367879-AMC368659

MINING CLAIM STATUS REPORT

STATUS:

MTP CHECKED BY TEJ

GEO CHECKED BY TEJ

PRE-ADJ BY _____

FINAL ADJ BY Y. [Signature] 12/21/05

LEAD SERIAL NO. AMC 368387 THROUGH AMC 368388

# _____	LODE	LOCATION FEE @ \$30 =	\$ <u>60</u>
# _____	PLACER	PROCESSING FEE @ \$15 =	\$ <u>30</u>
# <u>2</u>	ASSOCIATION PL	MAINTENANCE FEE @ \$125 =	\$ <u>250</u>
# _____	MILL SITE	OVERAGE	\$ _____
# _____	TUNNEL SITE	SHORTAGE	\$ _____
		OTHER FEES	\$ _____
		TOTAL	\$ <u>340.00</u>

OVER-THE-COUNTER MAIL TIMELY FILED: YES NO

LEGAL DESCRIPTION: T 7N R 4W SEC 23
 T 7N R 3W SEC 8
 T _____ R _____ SEC _____
 T _____ R _____ SEC _____

JURISDICTION: BLM FOREST SERVICE

WILDERNESS AREA: NO YES

SPLIT ESTATE: SX PX SRHA OTHER N/A
 PROPER NOTICE FILED IF LOCATED ON SRHA LANDS: YES NO N/A

RECONVEYED MINERALS ON BLM LANDS REQUIRE OPENING ORDERS FROM 1944 TO 1993. OPEN TO ENTRY ON: _____ N/A

SUBJECT TO PL 359: YES NO

STATUS; VOID PARTIALLY VOID PRIVATE MINERALS
 WITHDRAWN LANDS OTHER

CLAIMANT ACKNOWLEDGES THAT PORTIONS OF THE FOLLOWING CLAIM(S)/SITE(S): _____
 MAY BE VOID OR VOIDABLE. Signature of Claimant: _____

COMMENTS: _____

LOCATION NOTICE FOR PLACER MINING CLAIM

NOTICE IS HEREBY GIVEN that the Rainbows End #8 placer mining claim has been located by Ted + Sheila Bigelow, whose current mailing address is PO. BOX 323 Wittmann, AZ. 85361

The general course of this claim is Square and it is situated in Maricopa / Yavapai County, Arizona.

This claim is 1320 feet in length and 1320 feet in width. This claim runs from the location monument on which this location notice is posted approximately 1280 feet in a E direction to the E end line and 1280 feet in a S direction to the S end line. This claim is marked by four monuments, one at each corner of the claim.

The location monument on which this notice is posted is situated within Section 8, Township 7 N, Range 3 W, Gila Salt River Base and Meridian, Arizona. This claim encompasses portions of the following legal subdivisions (s) (if located by legal subdivisions) or the following quarter section (s), section (s), Township (s) and Range (s) NW 1/4 SE 1/4 Sec. 8 T7NR3W, Gila Salt River Base and Meridian, Arizona.

The locality of this claim with reference to some natural object or permanent monument and additional information (if any) concerning its locality are as follows: that 40+-ACRES of which the NWC is located near that USGS 1/2 sec. marker common to sec's 7+8 T7NR3W

DATED AND POSTED on the ground this 10th day of Nov., 2005.

BLM DATE STAMP

RECEIVED
B.L.M. AZ STATE OFFICE
2005 NOV 21 P 12:40

LOCATOR (s)
T Bigelow

AMC 368387

BLM DATE STAMP

RECEIVED
B.L.M. AZ STATE OFFICE

2005 NOV 21 P 12: 41

PHOENIX, AZ

CLAIM MAP

Lode () Placer (✓)

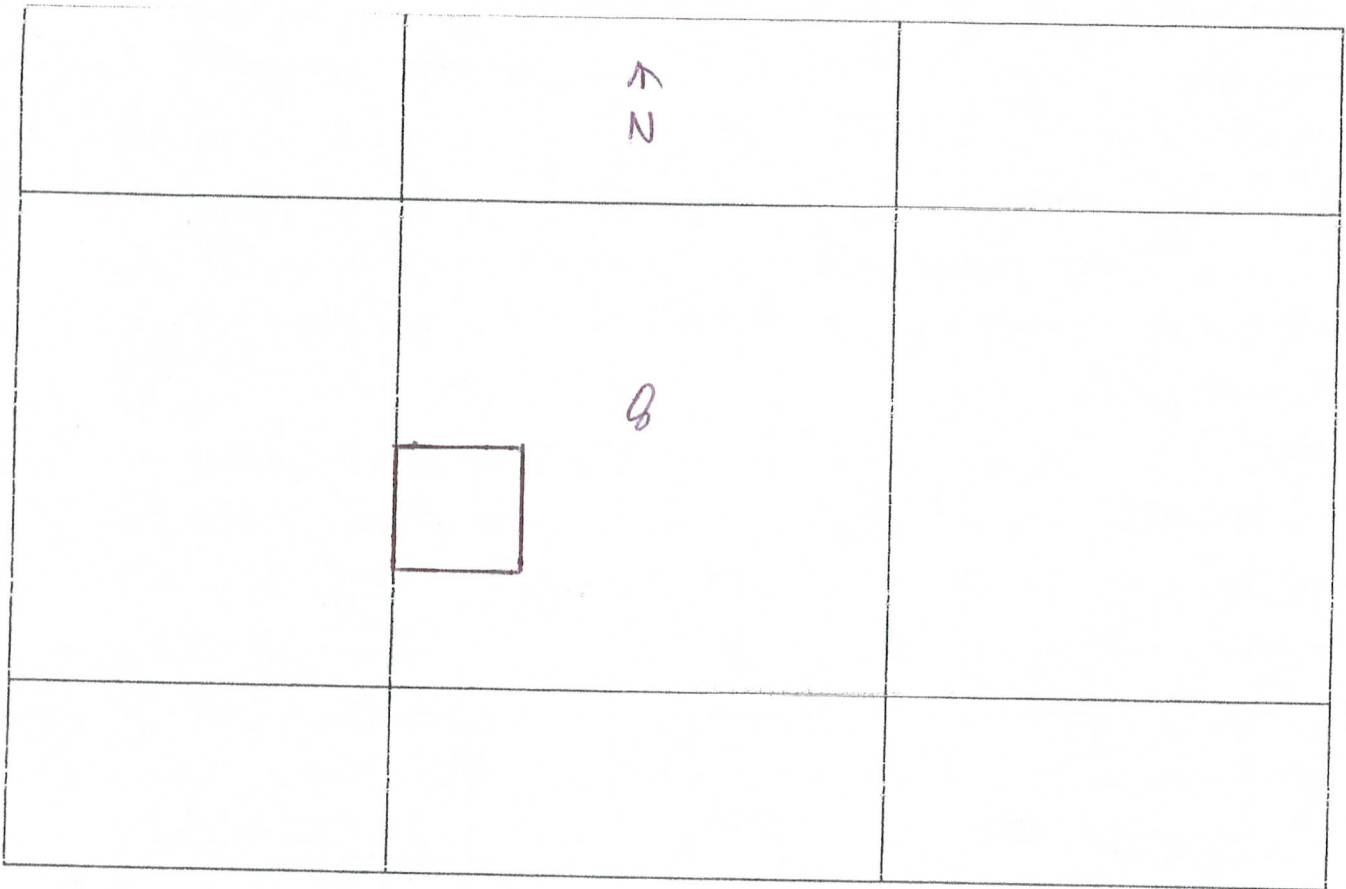

AMB 368387

Scale: 1" = _____

NW 1/4 SE 1/4

1. The above map depicts the RAINBOW'S END #8 mining claim, which is located in Section (s) 8, Township 7N, Range 4W, Gila and Salt River Base and Meridian, Maricopa / Yavapai County, Arizona.

2. The type of corner and location monuments used are as follows: 1.5" x 4' PVC

3. The bearings and distances in degrees and feet between claim corners are as depicted on the map.

Note: Drawing not to scale.

LOCATION NOTICE FOR PLACER MINING CLAIM

NOTICE IS HEREBY GIVEN that the Thunder Canyon #23 placer mining claim has been located by Ted & Sheila Bigelow, whose current mailing address is P.O. BOX 323 Wittmann, Az. 85361

The general course of this claim is Square and it is situated in Maricopa County, Arizona.

This claim is 1320 feet in length and 1320 feet in width. This claim runs from the location monument on which this location notice is posted approximately 1280 feet in a N direction to the N end line and 1280 feet in a W direction to the W end line. This claim is marked by four monuments, one at each corner of the claim.

The location monument on which this notice is posted is situated within Section 23, Township 7 N, Range 4 W, Gila Salt River Base and Meridian, Arizona. This claim encompasses portions of the following legal subdivisions (s) (if located by legal subdivisions) or the following quarter section (s), section (s), Township (s) and Range (s) S.W. 1/4 S.W. 1/4 Sec. 23 T7NR4W, Gila Salt River Base and Meridian, Arizona.

The locality of this claim with reference to some natural object or permanent monument and additional information (if any) concerning its locality are as follows: That 40+ Acres of which the SWC is located at that USGS. Corner marker common to sec's 22, 23, 26 & 27 T7NR4W GSRB&M.

DATED AND POSTED on the ground this 10th day of Nov., 2005.

BLM DATE STAMP

RECEIVED
B.L.M. AZ STATE OFFICE
2005 NOV 21 P 12:41
PHOENIX, AZ

LOCATOR (s)
T Bigelow

AMB 368388

BLM DATE STAMP

RECEIVED
B.L.M. AZ STATE OFFICE

2005 NOV 21 P 12:41

PHOENIX, AZ

CLAIM MAP

Lode () Placer (✓)

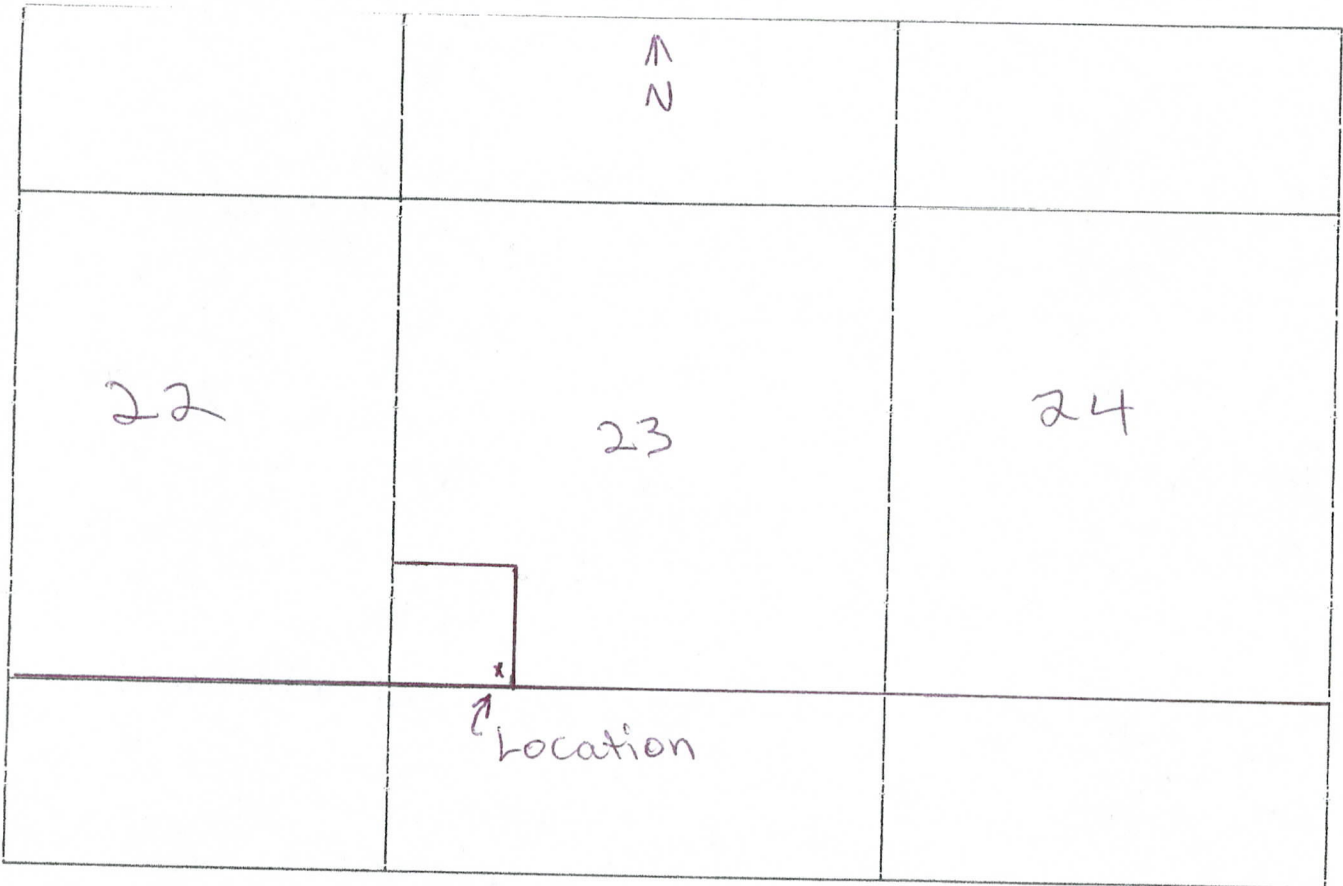

AMC 368388

Scale: 1" = _____

1. The above map depicts the Thunder Canyon #23 ^{sw $\frac{1}{4}$ sw $\frac{1}{4}$} mining claim, which is located in Section (s) 23, Township 7N, Range 4W, Gila and Salt River Base and Meridian, Maricopa County, Arizona.

2. The type of corner and location monuments used are as follows: 1.5" x 4' PVC

3. The bearings and distances in degrees and feet between claim corners are as depicted on the map.

Note: Drawing not to scale

RUN TIME: 12:02 PM

UNITED STATES DEPARTMENT OF INTERIOR
BUREAU OF LAND MANAGEMENT
GEOGRAPHIC REPORT WITH LAND
Sorted by Serial Number

RUN DATE: 11/21/2005
Page 1 of 1

Serial Number: AZA 031569
Total Case Acres: 1.000

<u>Casetype</u>	<u>Case Disp</u>				<u>Sect</u>	<u>Sur Typ</u>	<u>Sur Num</u>	<u>Suff</u>	<u>Subdivision</u>	<u>Act Pend</u>
837000	AUTHORIZED	14	0070N	0040W	023	FF			PORTION OF;	

Input Parameters for Geographic Report with Land

System Id = CR

Admin State = AZ

Geo State =

Casetype Begins With

Case Disp Txt = AUTHORIZED, CANCELLED, EXPIRED, PENDING, REJECTED, RELINQUISHED, VOID, WITHDRAWN

Mer Twp Rng =

Section =

Mtrs = 14 0070N 0030W 008, 14 0070N 0040W 023

Commodity =

Commodity Txt =

Pending Org =

Pend Org Decode =

Total Rows Returned: 1